



500  
SLENDERLINE SLIDING WINDOW

**General Documentation Disclaimer**

This manual is intended as a manufacturing and installation advisory document. For correct specifications, sizing of profiles and structural information please consult the StarFront Application. If the information you require is not available through the StarFront Application, please contact your stockist before proceeding. It is advisable to have all sizing and performance criteria checked by a qualified structural engineer to ensure that the required criteria will be met.

All information, recommendations or advice contained in this documentation is given in good faith to the best of Wispeco's knowledge and is based on current procedures in effect.

Since the actual use of this documentation by the user is beyond the control of Wispeco, such use is within the exclusive responsibility of the user. Wispeco cannot be held responsible for any loss incurred through incorrect or faulty use of this documentation. Training of Wispeco systems is important for ensuring correct procedures in the manufacturing of products.

Great care has been taken to ensure that the information provided is correct.

Ensure that you have the latest available manual. The revision number and date can be checked on the latest StarFront version.

Wispeco will accept no responsibility for any errors and/or omissions, which may have inadvertently occurred.

**Specifications concerning products and applications**

This manual is based on standard configurations only. As there are many configurations not covered in this manual, contact your stockist with regards to a configuration not represented herein if required.

AutoDesk drawings (CAD Symbol Library) are available on request and can be issued with the consent of the Wispeco Technical Department.

All mechanical joints must be sealed with a **Crealco approved joint sealer**. Failure to correctly seal the joints can affect the performance of the system. Information on joint sealing can be found in the Cleaning & Maintenance Manual\*\* available for download from [www.crealco.co.za](http://www.crealco.co.za) or from StarFront.

All drawings in the Wispeco Documentation are NOT to scale and are used for illustrative purposes only.

Wispeco will not accept responsibility for the use of standard products since Wispeco does not know where these products are being installed.

The hardware recommended in this documentation is suitable for use in most atmospheric environments. When hardware is used in severe coastal environments the manufacturer of the hardware must be consulted.

For the coastal regions and any other high corrosion areas, the following is advised: to minimize phylliform corrosion use SurTec650 RTU spray during the manufacturing of aluminium profile systems. This should be applied, before assembly, on all pre-work aluminium where the powder coating covering has been removed thereby exposing the raw aluminium base.

The use of non-specified hardware or incorrect mechanical fasteners can adversely affect the mechanical and weathering performance of the system and we strongly advise against deviations. A Wispeco Consultant can advise you of any hardware issues and limitations with regard to this system.

The use of anti-magnetic stainless steel screws and aluminium pop rivets is recommended to reduce galvanic corrosion in harsh environments.

Fixing lugs on frames must be positioned as per the user manual and used in accordance to the AAMSA specifications. When profiles are screwed together the screw centres must also be according to the user manual or as specified by an engineer.

All glass used within Wispeco products must comply with SAGGA regulations. Laminated glass must not stand in water.

**\*\*For Cleaning and Maintenance of this system please download the Wispeco Installation, Cleaning and Maintenance Procedures from the Crealco website ([www.crealco.co.za](http://www.crealco.co.za)).**

**By continuing to use this documentation you acknowledge that you understand and accept the legal disclaimer.**

This manual must be read in conjunction with the Installation, Cleaning & Maintenance Document and the Performance Certificates for the relevant system. The manual must also be used in conjunction with the design and cutting list from the latest version of StarFront.

<b>Index .....</b>	<b>ii</b>
<b>Legal Disclaimer.....</b>	<b>1</b>

<b>General System</b>	
Profile Identification.....	2
Hardware Components.....	3
Size Limitation Guide.....	4
Fixing Details.....	5
Vertical Cross-Sectional Detail.....	
showing Sill Rail.....	6
showing Hollow Sill Rail.....	7
showing High Rise Sill.....	8
Horizontal Cross-Sectional Detail.....	
showing OX Configuration.....	9
showing XOX Configuration.....	10
showing OXXO Configuration.....	11
Frame Assembly Detail.....	
Outer Frame.....	12
Sash Frame.....	13
Floor Level Detail.....	
Sill.....	14
Hollow Sill.....	15
Machining Detail.....	
Sill.....	16
Hollow Sill.....	17
Jamb Rail.....	18-19
Sash Outer Jamb.....	20
Inner Sash Outer Jamb.....	21
Sash Interlocker.....	22
Inner Sash Interlocker.....	23
Sill Baffle Plate.....	24
High Rise Sill.....	25
Assembly Detail.....	
Handle.....	26
Anti-Lift Block.....	27
AAMSA Test.....	28
Glazing Procedure.....	29

# 500 SLENDERLINE SLIDING WINDOW PRODUCT MANUAL

## Profile Identification

### Series 500 Window Profiles



DIE No. W27603 500 Sill  
Baffle Plate

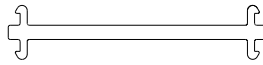

DIE No. W24497 500 Coupling Mullion  
Only for W52007



DIE No. W14014 500 Sill Exit



DIE No. W28475 500 Sash  
Head & Sill

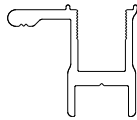

DIE No. W28476 500 Sash  
Outer Frame

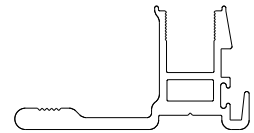

DIE No. W53888 500 Sash  
interlocker

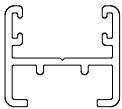

DIE No. W28482 500 OXXO  
Adaptor

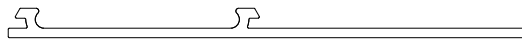

DIE No. W26364 500 Fixing Lug

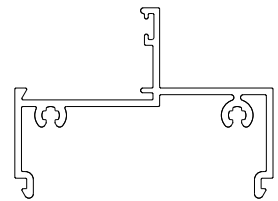

DIE No. W28481 Cas30.5 54mm  
Outer Frame

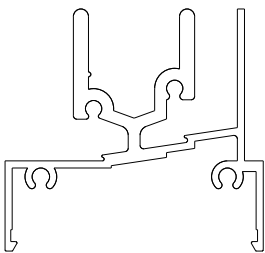

DIE No. W24494 500 Sill Rail

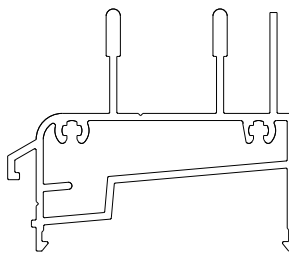

DIE No. W53322 500 Hollow Sill Rail

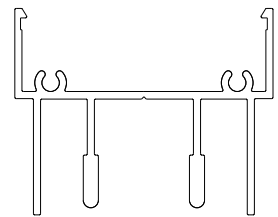

DIE No. W24498 500 Head Rail

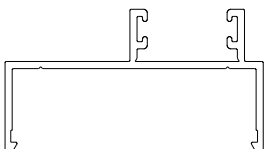

DIE No. W24496 500 Jamb Rail

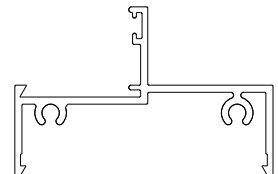

DIE No. W52007 Cas28 54mm  
Outer Frame



This manual must be read in conjunction with the Installation, Cleaning & Maintenance Document and the Performance Certificates for the relevant system. The manual must also be used in conjunction with the design and cutting list from the latest version of StarFront.

# 500 SLENDERLINE SLIDING WINDOW PRODUCT MANUAL

## Hardware Components

### RECOMMENDED SERIES 500 COMPONENTS

All hardware is available through our Stockists as well as through Crealco Components, and can be viewed on [www.crealco-components.com](http://www.crealco-components.com)

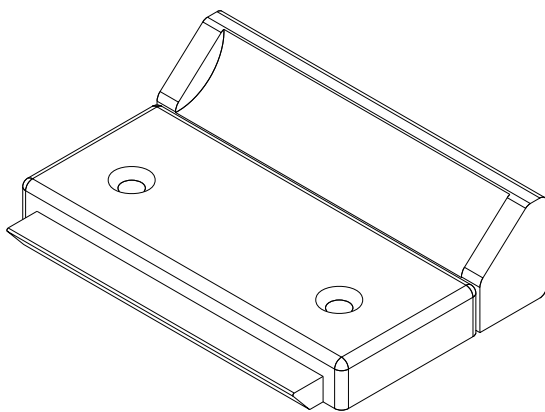

**SDW-500-NYL**  
Nylon Slider Handle  
60mm

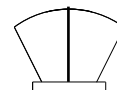

**GFP-4850**  
Finpile

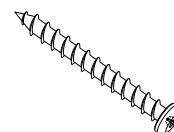

**FSP-0830P-SS**  
P/Head POSI  
8x30 S/S Screw

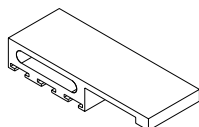

**PEX-500TB**  
Draught Excluder  
Top And Bottom

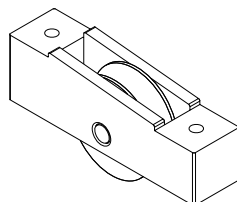

**RSW-500-NYL**  
Roller Nylon With Stainless  
Steel pin

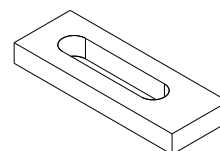

**SGD-ALS500**  
Anti Lift Block

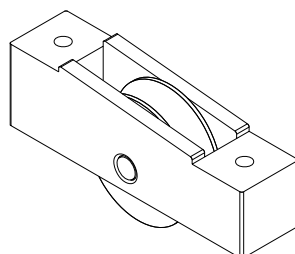

**RSW-500-SS**  
Roller Stainless Steel  
With Bearing Assembly

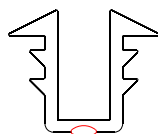

**GCH-CR**  
Red Pip = 4mm Glass

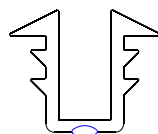

**GCH-CB**  
Blue Pip = 5mm Glass

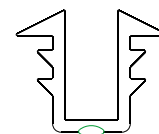

**GCH-CSG**  
Green Pip = 6.38mm Glass

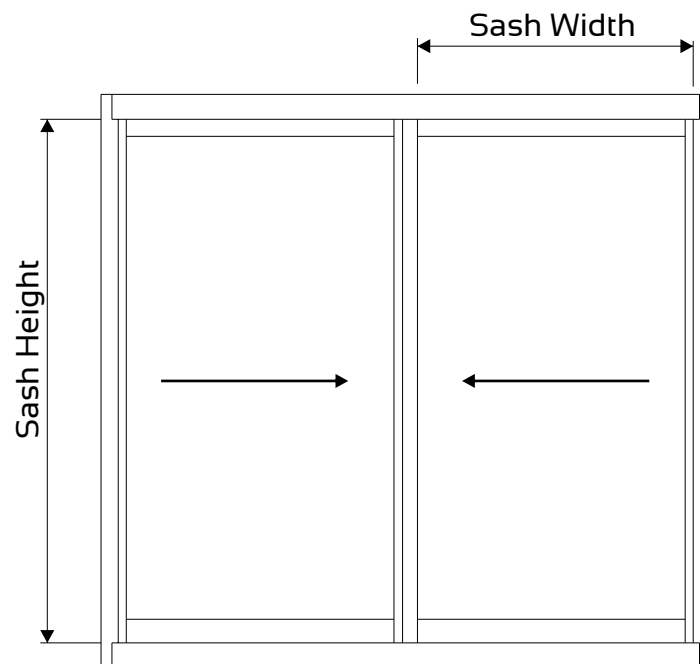

MAXIMUM SASH WIDTH = 750mm

MAXIMUM SASH HEIGHT = 1500mm

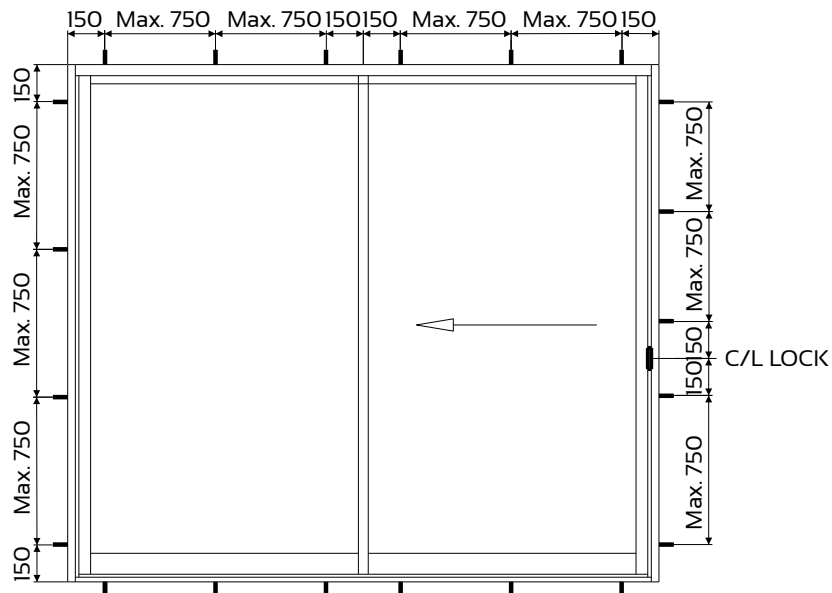

TYPICAL OX SLIDING DOOR &  
HORIZONTAL SLIDING WINDOW

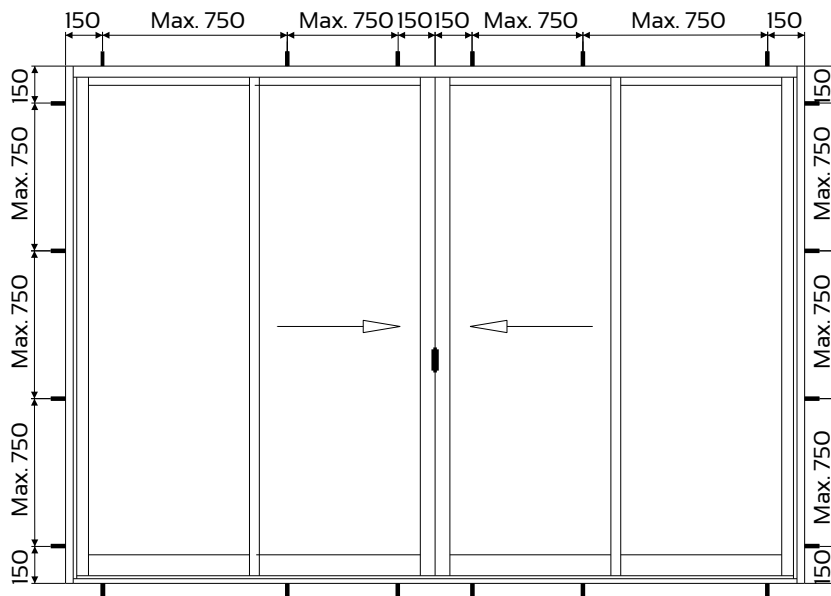

TYPICAL OXXO SLIDING DOOR &  
HORIZONTAL SLIDING WINDOW

**500**  
SLENDERLINE SLIDING WINDOW  
**PRODUCT MANUAL**

**Vertical Cross Sectional Detail**

Showing Sill Rail

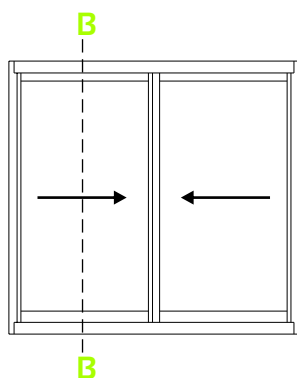

**SECTION B-B**  
Section not to scale

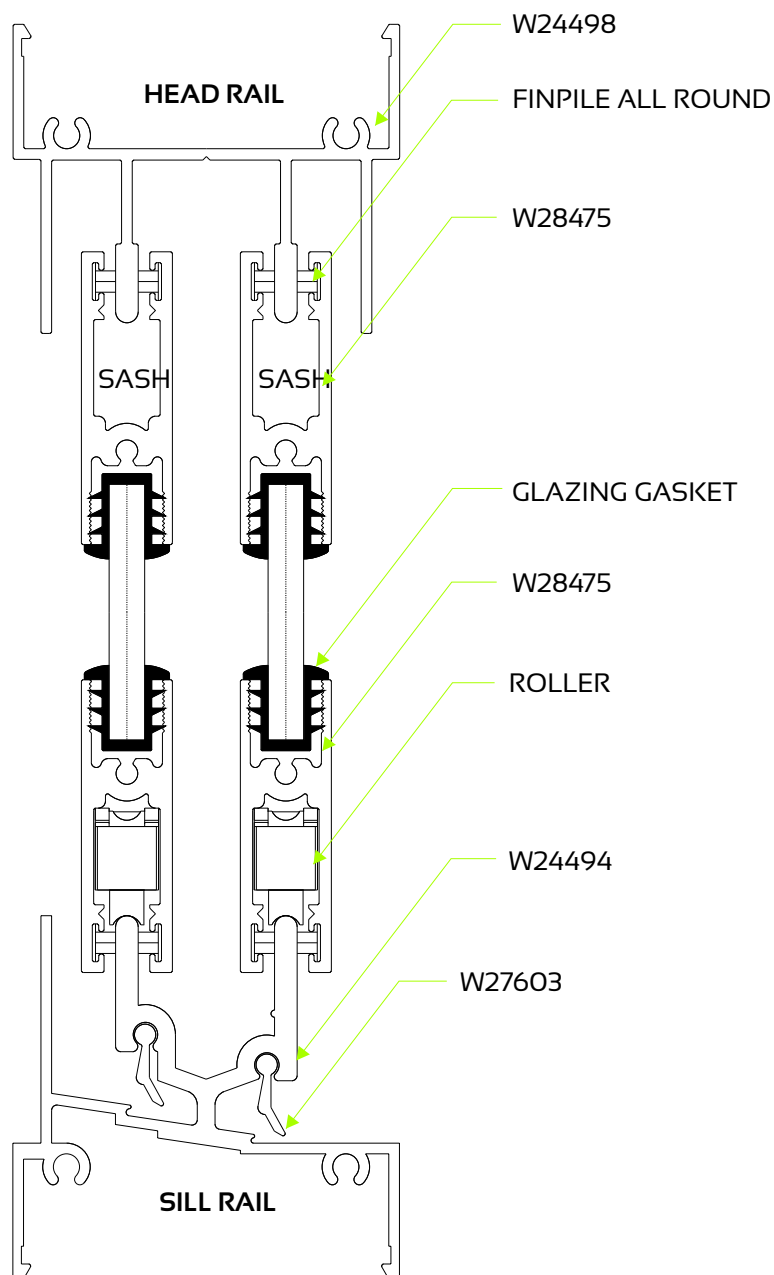



## Vertical Cross Sectional Detail

Showing Hollow Sill Rail

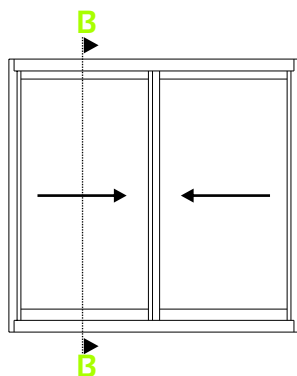

**SECTION B-B**  
Section not to scale

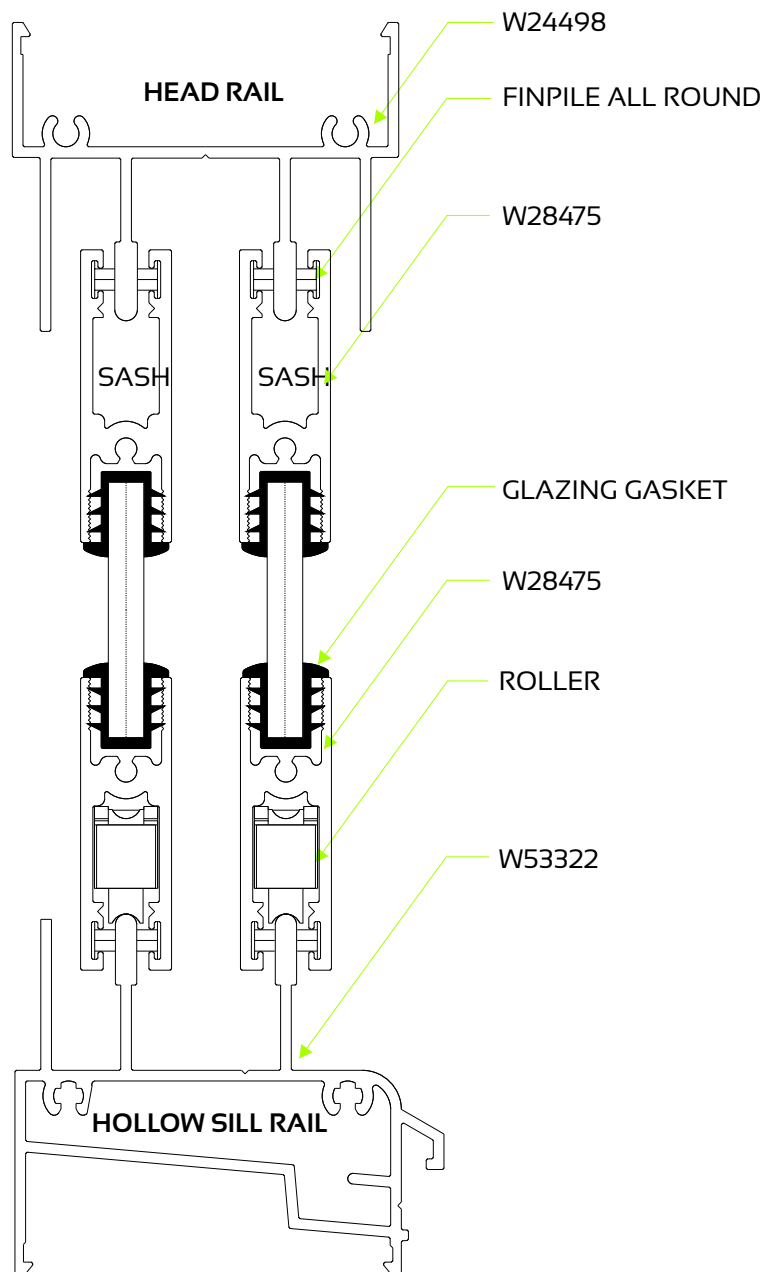

500

SLENDERLINE SLIDING WINDOW

## PRODUCT MANUAL

### Vertical Cross Sectional Detail

Showing High Rise Sill Rail

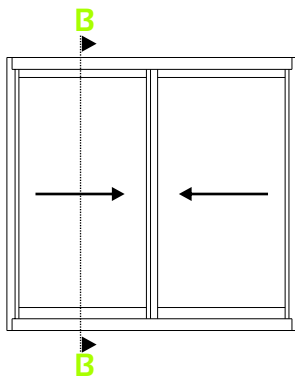

#### SECTION B-B

Section not to scale

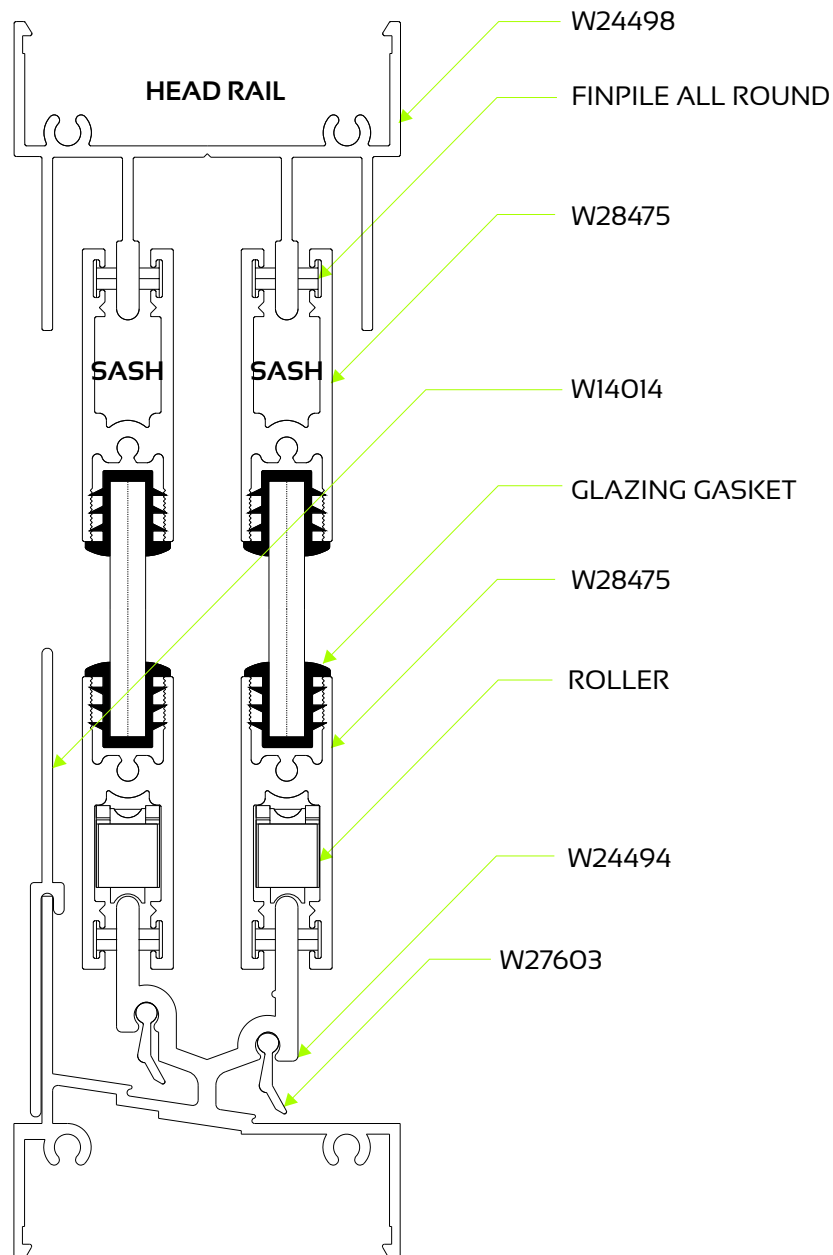

500

SLENDERLINE SLIDING WINDOW

## PRODUCT MANUAL

### Horizontal Cross Sectional Detail

Showing OX Configuration

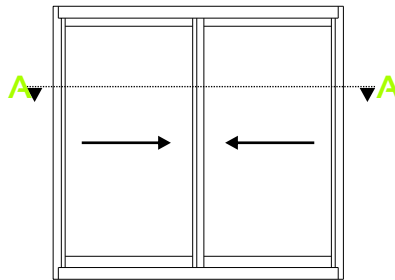

#### SECTION A-A

Section not to scale

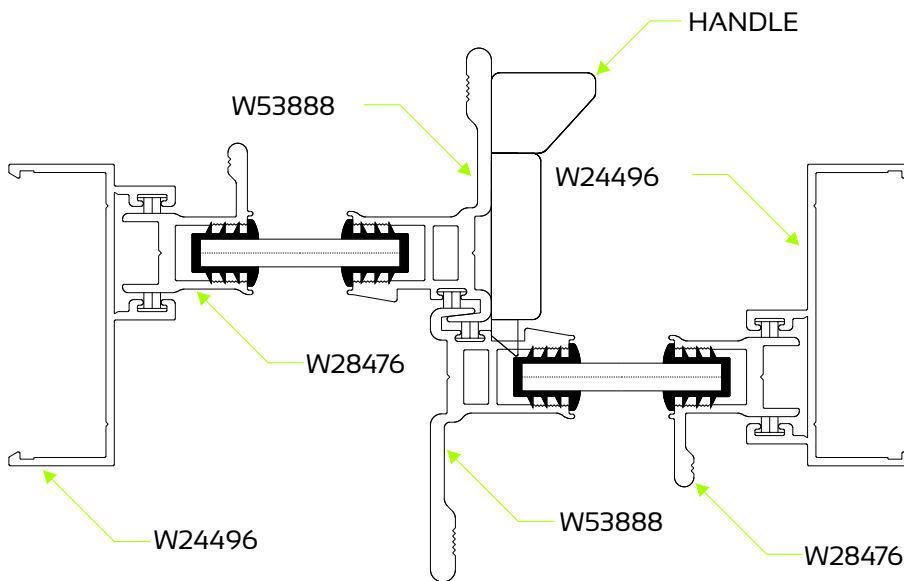

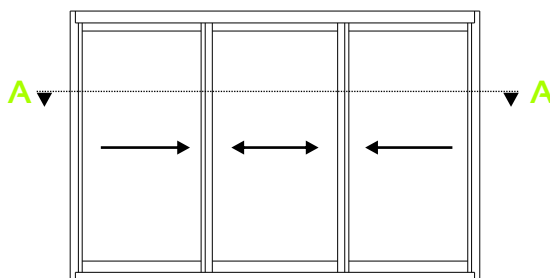

**SECTION A-A**  
Section not to scale

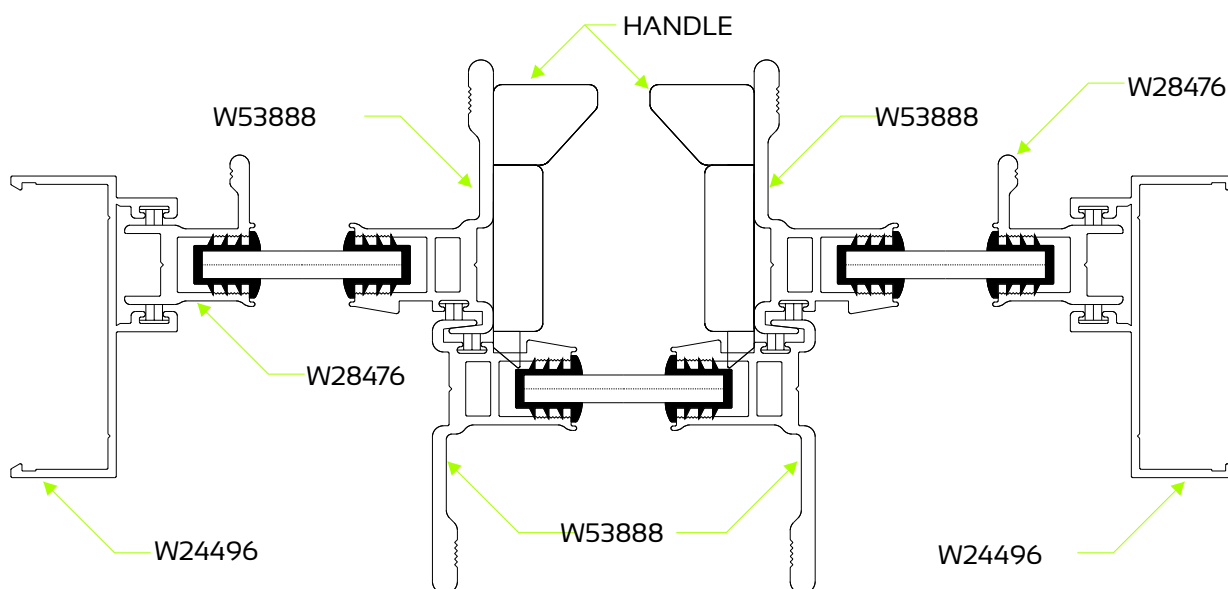

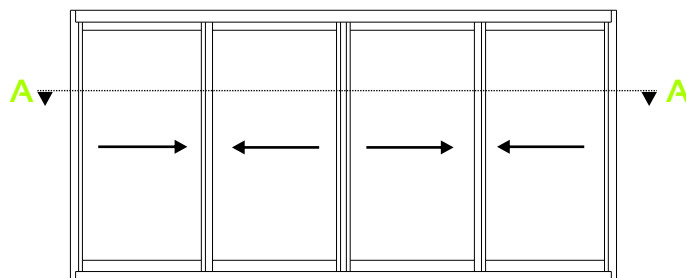

**SECTION A-A**

Section not to scale

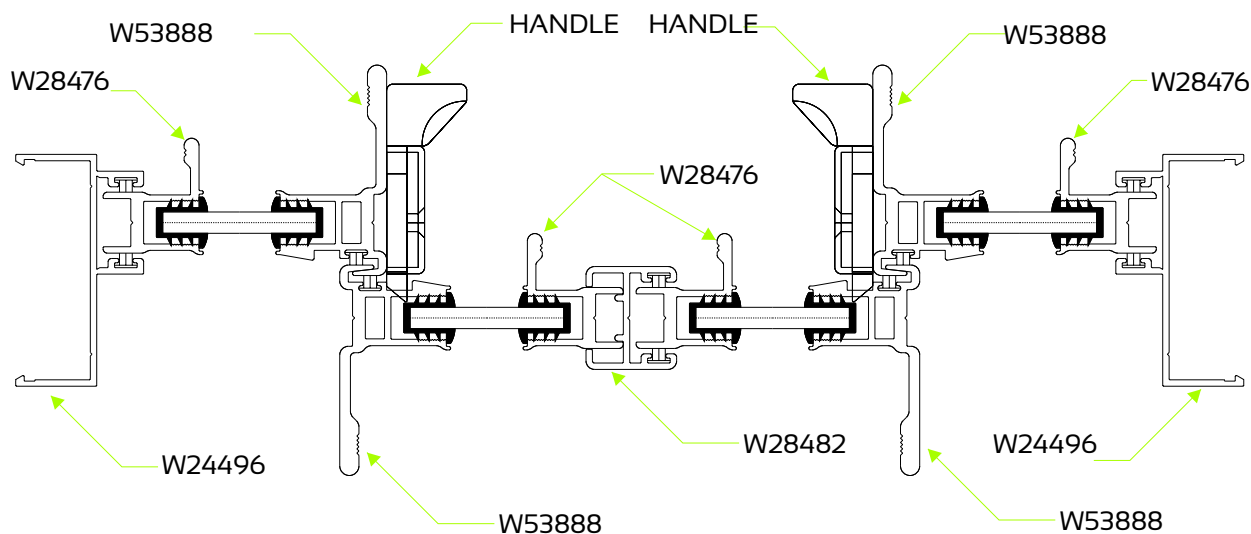

# 500 SLENDERLINE SLIDING WINDOW PRODUCT MANUAL

## Assembly Detail

### Outer Frame Component

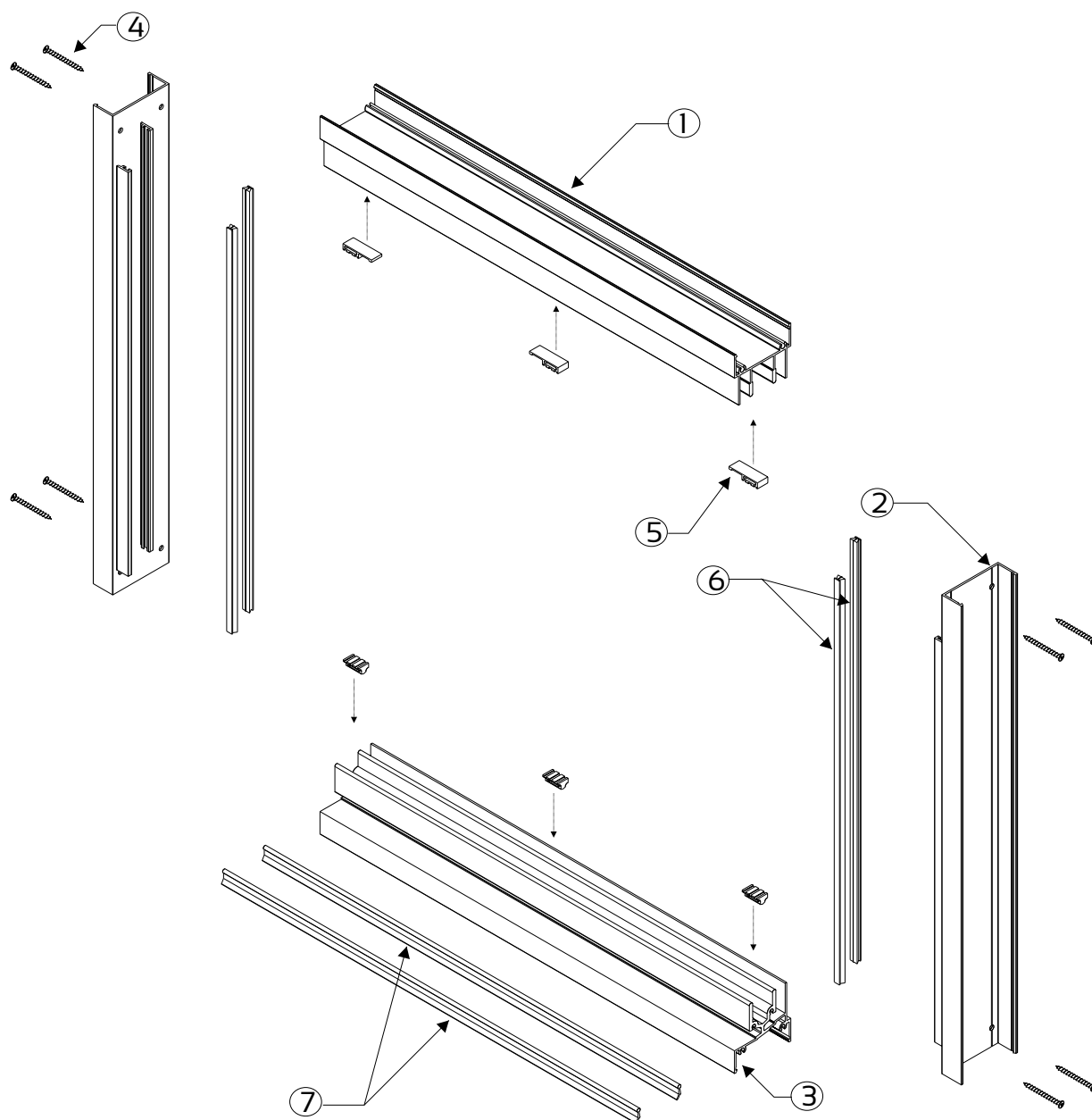

#### System Profiles

ITEM	QTY	DIE No.	DESCRIPTION
1	1	W24498	500 Head Rail
2	2	W24496	500 Jamb Rail
3	1	W24494	Sill Rail

#### Hardware

ITEM	QTY	COMPONENT DESCRIPTION
4	8	8x30 P/Head POSI 5/5 Screw
5	6	Draught Excluders
6	4	Finpile
7	2	Sill Baffle Plate



This manual must be read in conjunction with the Installation, Cleaning & Maintenance Document and the Performance Certificates for the relevant system. The manual must also be used in conjunction with the design and cutting list from the latest version of StarFront.

Disclaimer: The right to make alterations is reserved  
© 2013 Wispeco (Pty) Ltd, All Rights Reserved

# 500 SLENDERLINE SLIDING WINDOW PRODUCT MANUAL

## Assembly Detail

### Sash Frame Component

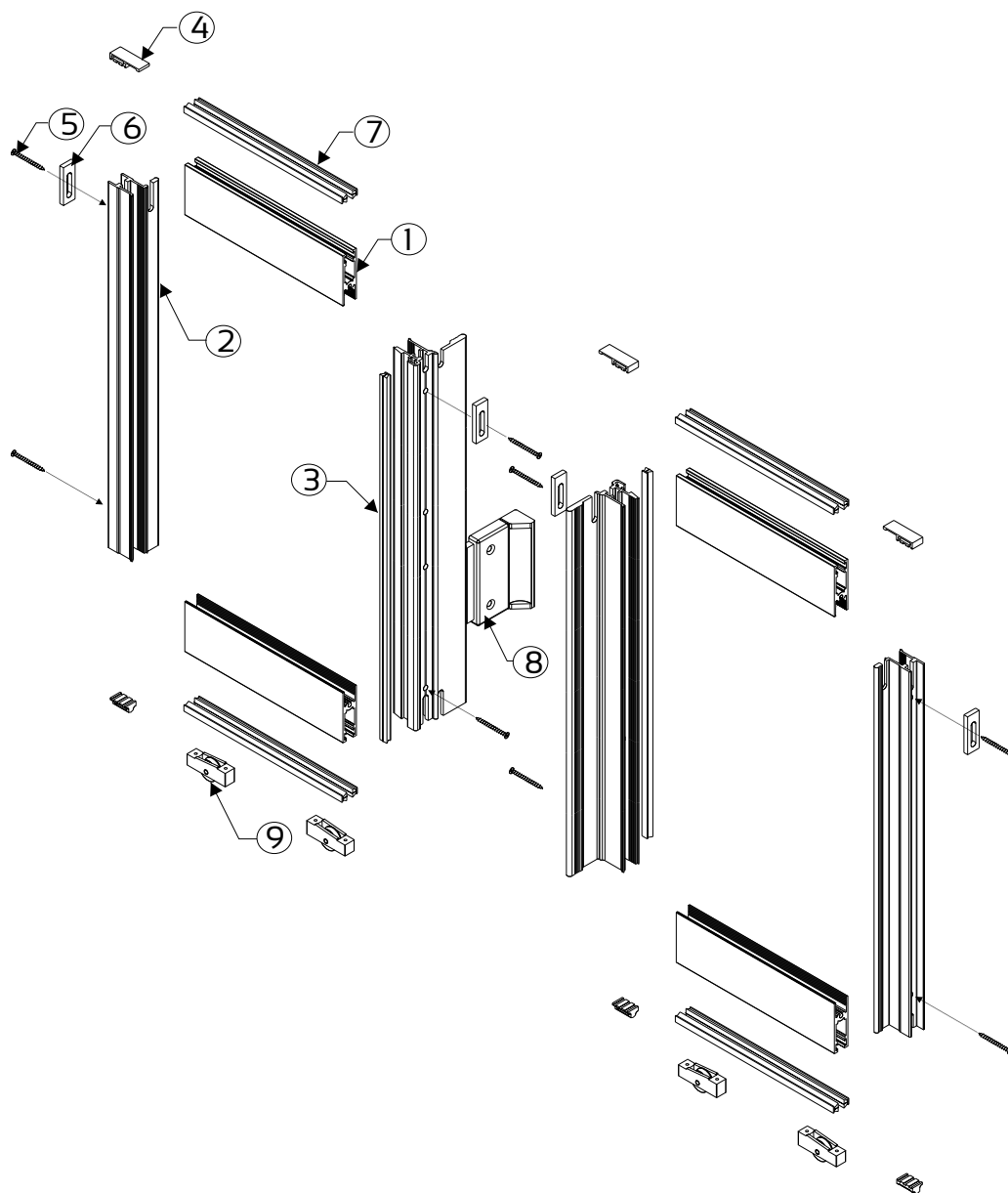

### System Profiles

ITEM	QTY	DIE No.	DESCRIPTION
1	4	W28475	500 Sash Head & Sill
2	2	W28476	500 Sash Outer Frame
3	2	W53888	500 Sash Interlocker

### Hardware

ITEM	QTY	COMPONENT DESCRIPTION
4	6	Draught Excluders
5	8	8x30 P/Head POSI S/S Screw
6	4	Anti Lift Block
7	8	Finpile
8	1	Nylon Slider Handle
9	4	Rollers



This manual must be read in conjunction with the Installation, Cleaning & Maintenance Document and the Performance Certificates for the relevant system. The manual must also be used in conjunction with the design and cutting list from the latest version of StarFront.

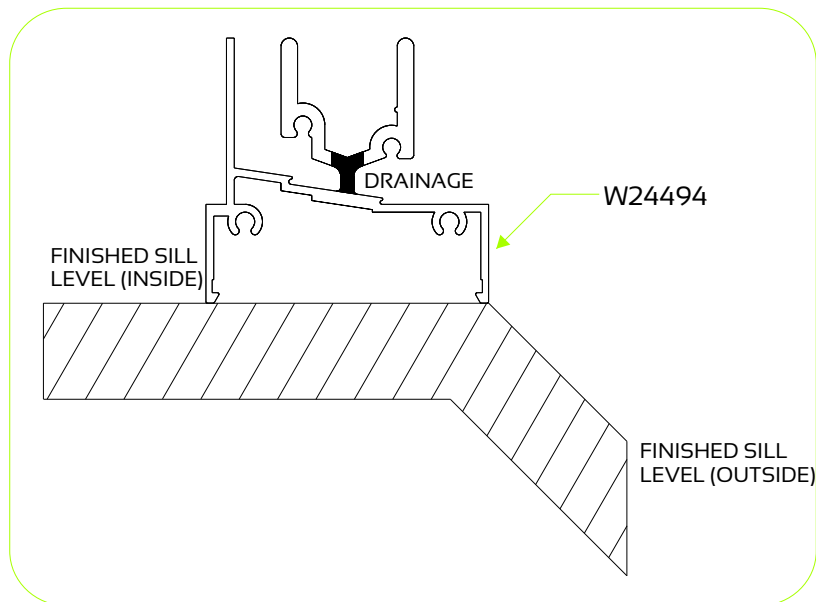
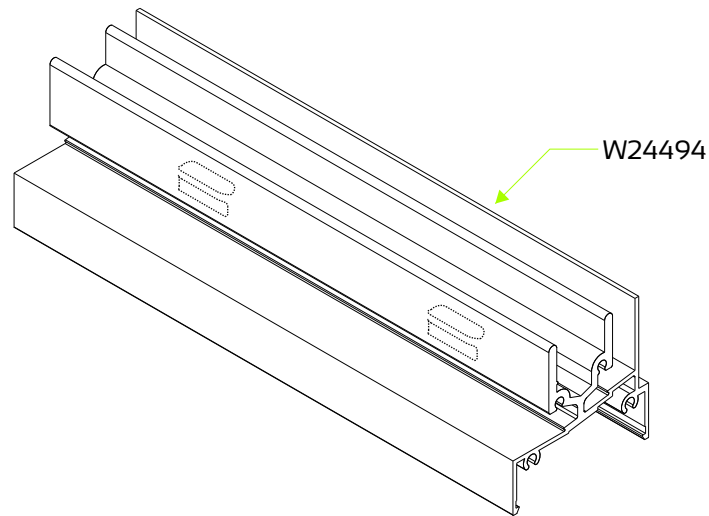



500

SLENDERLINE SLIDING WINDOW

## PRODUCT MANUAL

### Floor Level Detail

Hollow Sill

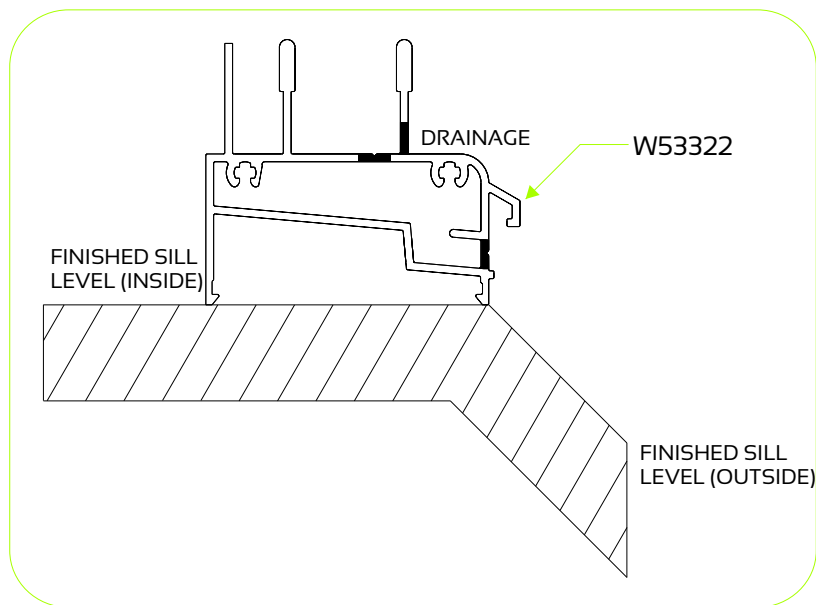
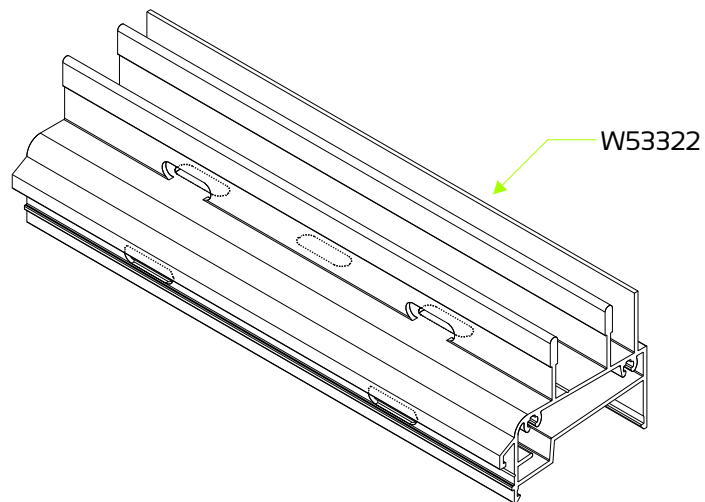

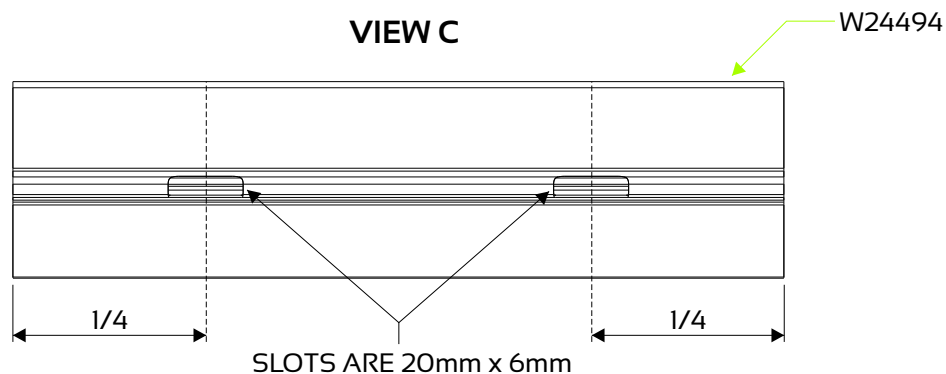
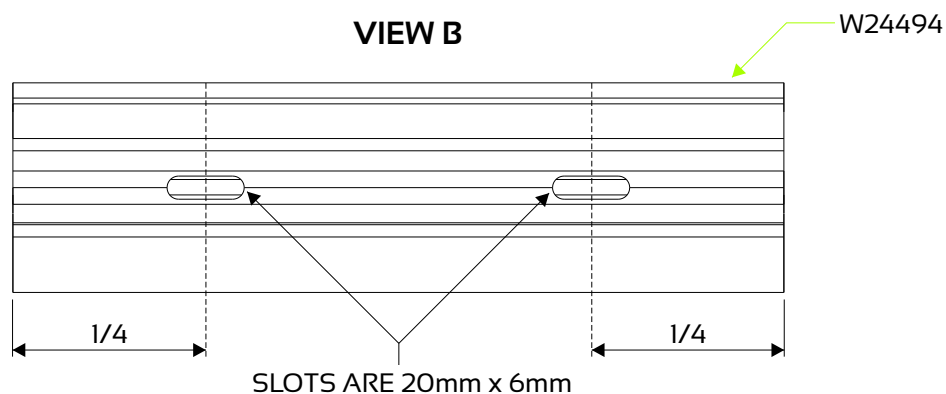
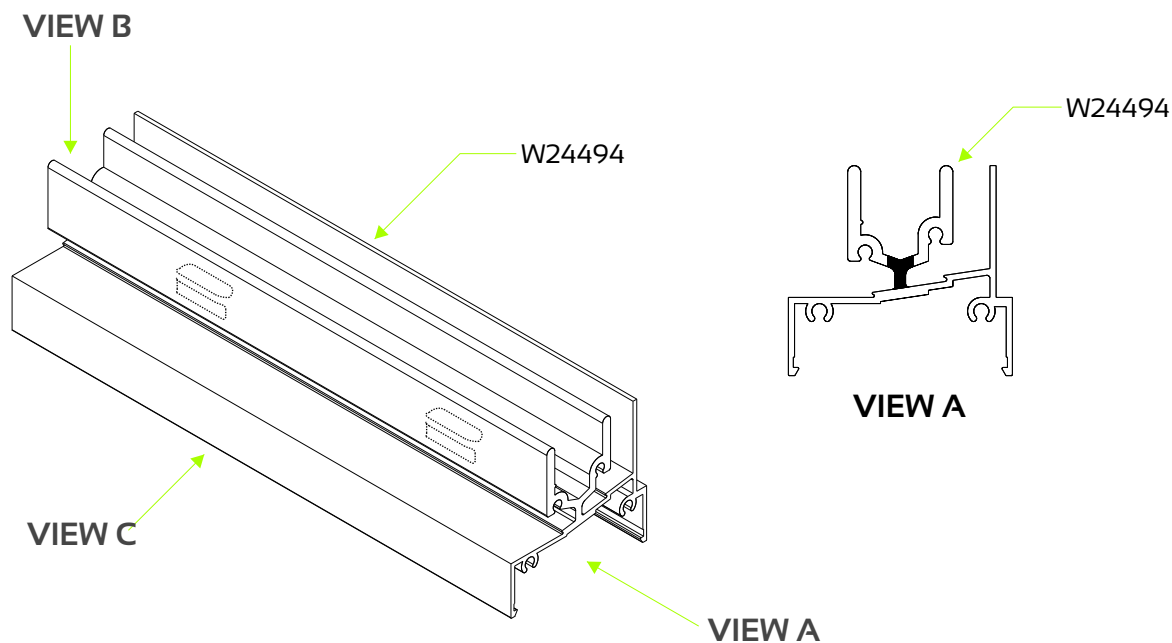

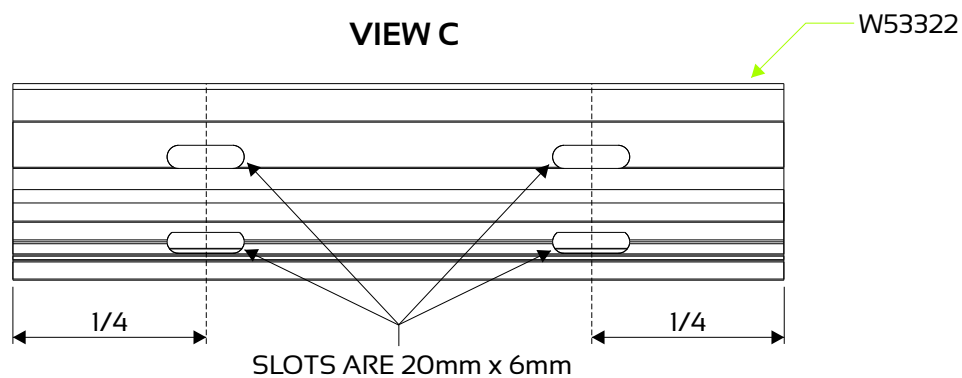
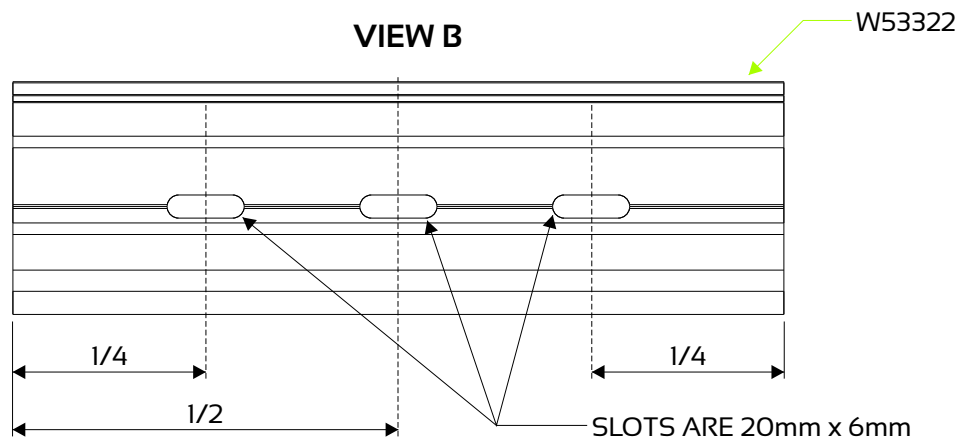
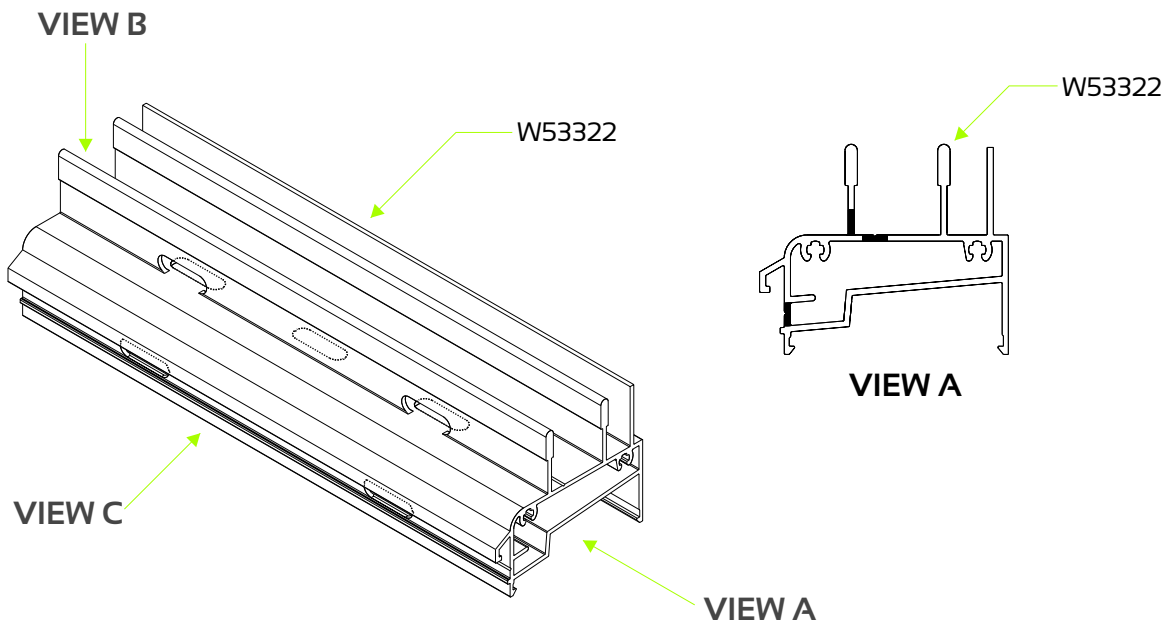

500

SLENDERLINE SLIDING WINDOW

# PRODUCT MANUAL

## Machining Detail

Jamb Rail

LHS Jamb Rail for OX Configuration/LHS & RHS Jamb Rail for OXXO Configuration

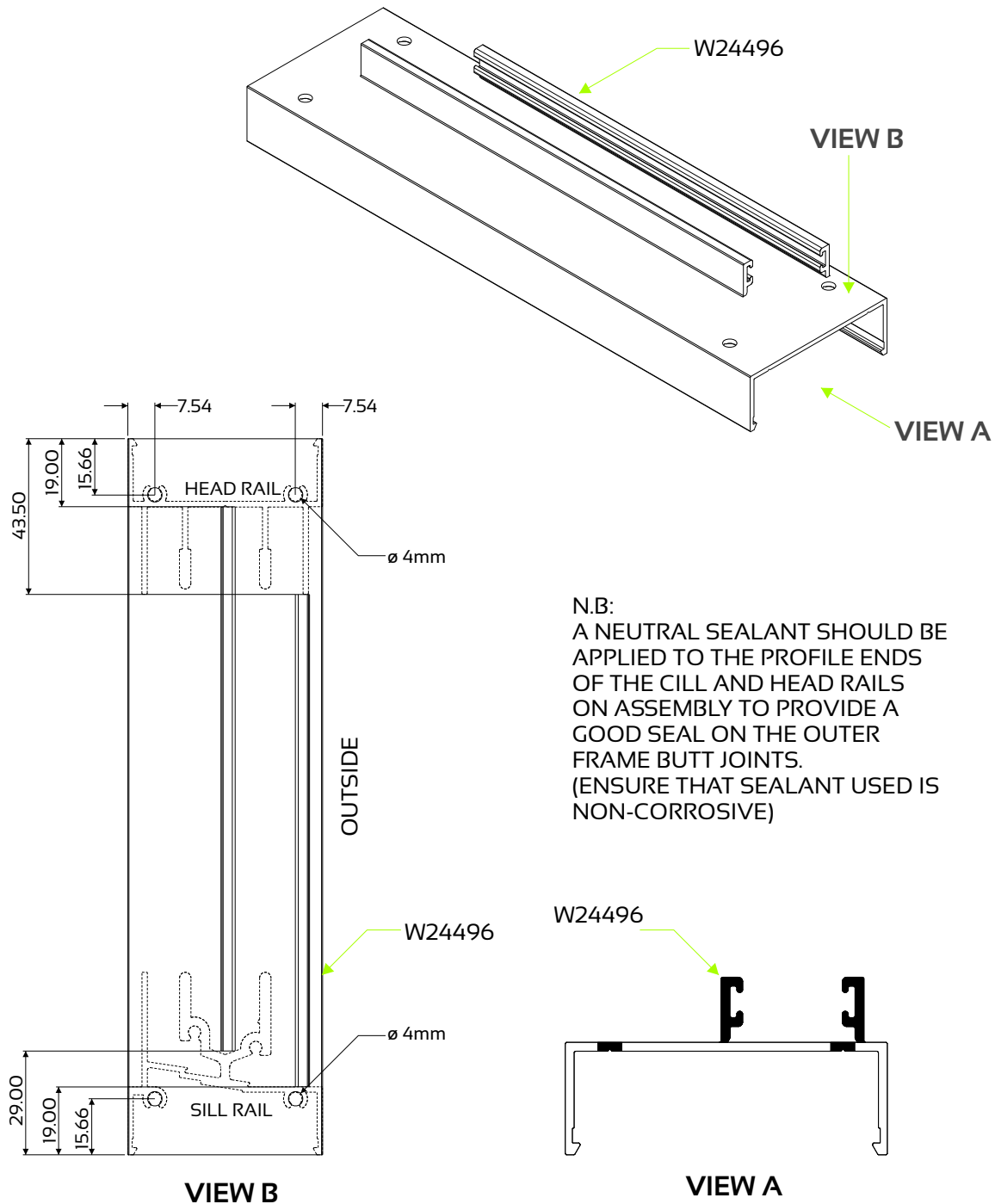

500

SLENDERLINE SLIDING WINDOW

# PRODUCT MANUAL

## Machining Detail

Jamb Rail, RHS Jamb Rail For OX Configuration

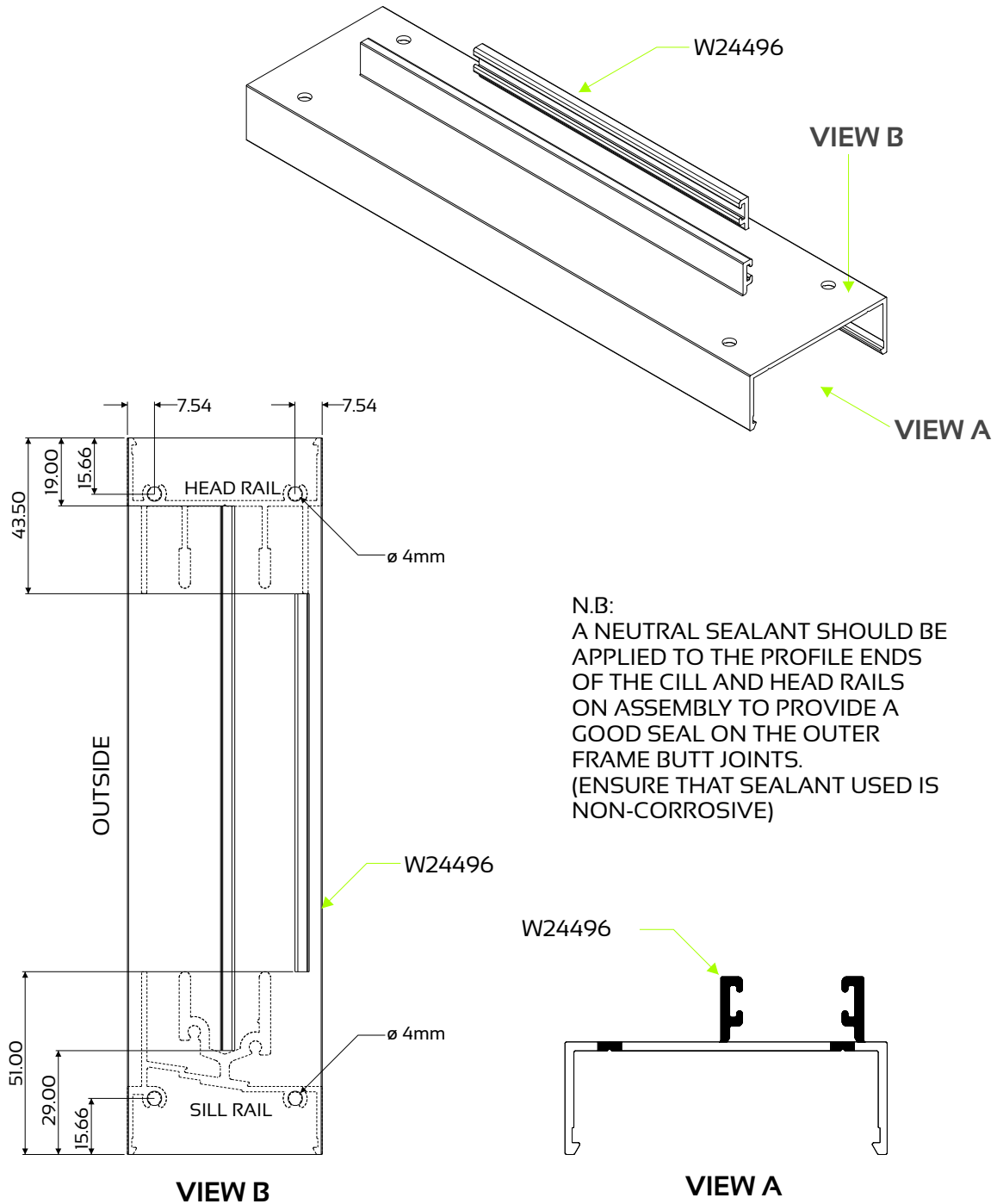

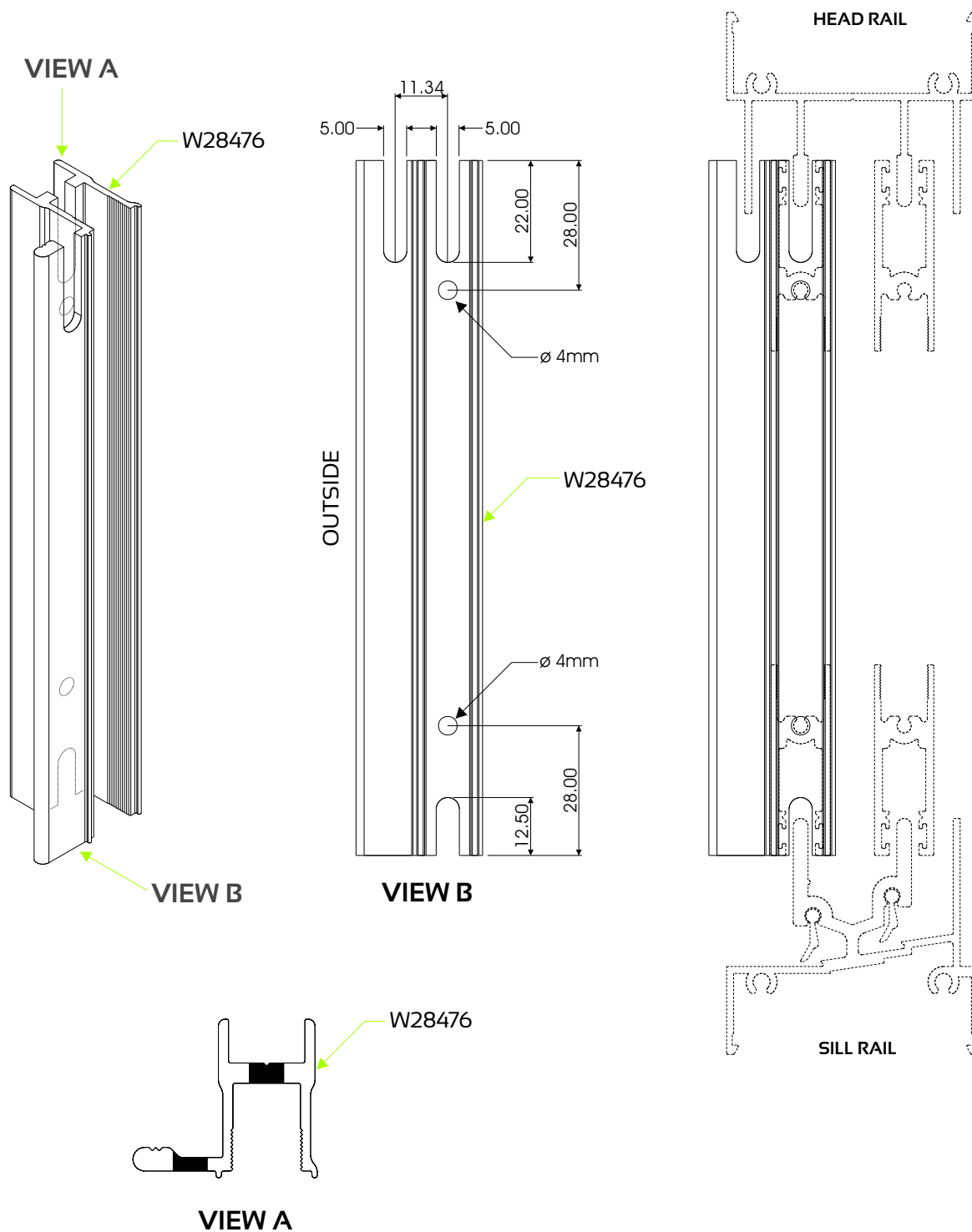

500

SLENDERLINE SLIDING WINDOW

# PRODUCT MANUAL

## Machining Detail

Inner Sash Outer Jamb

VIEW A

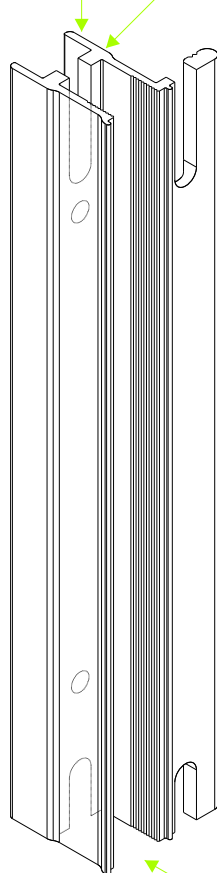

VIEW B

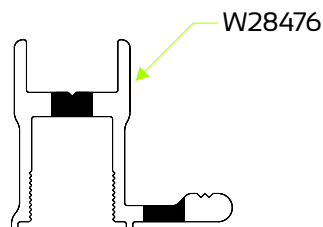

VIEW A

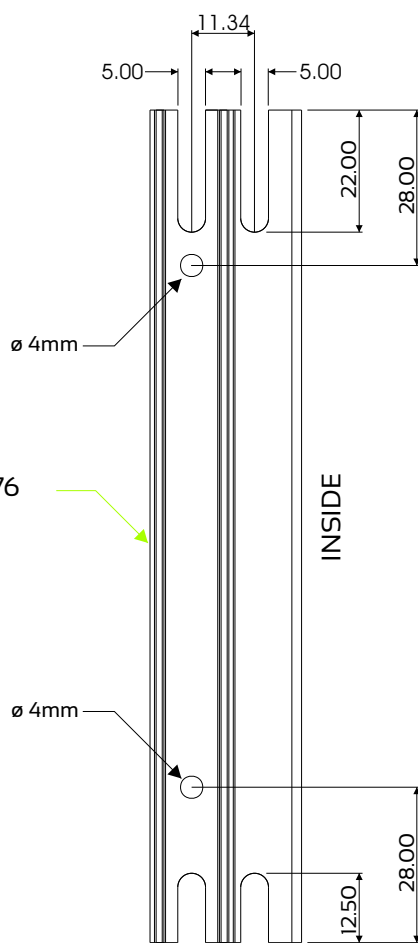

VIEW B

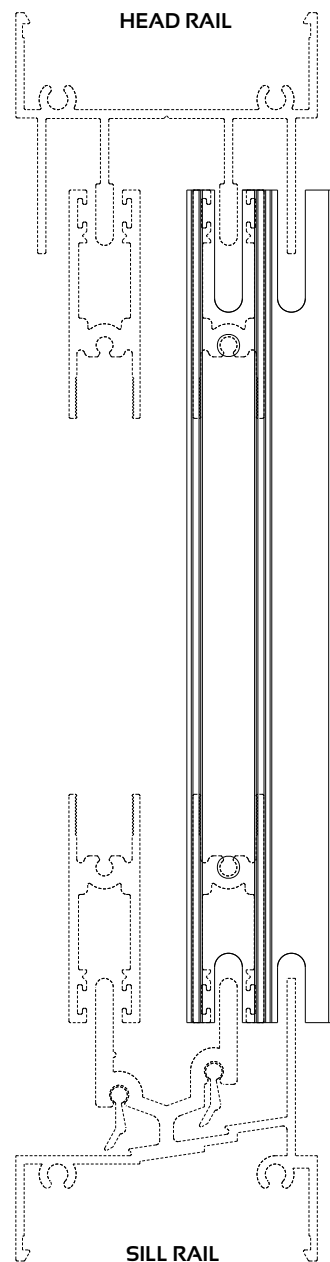

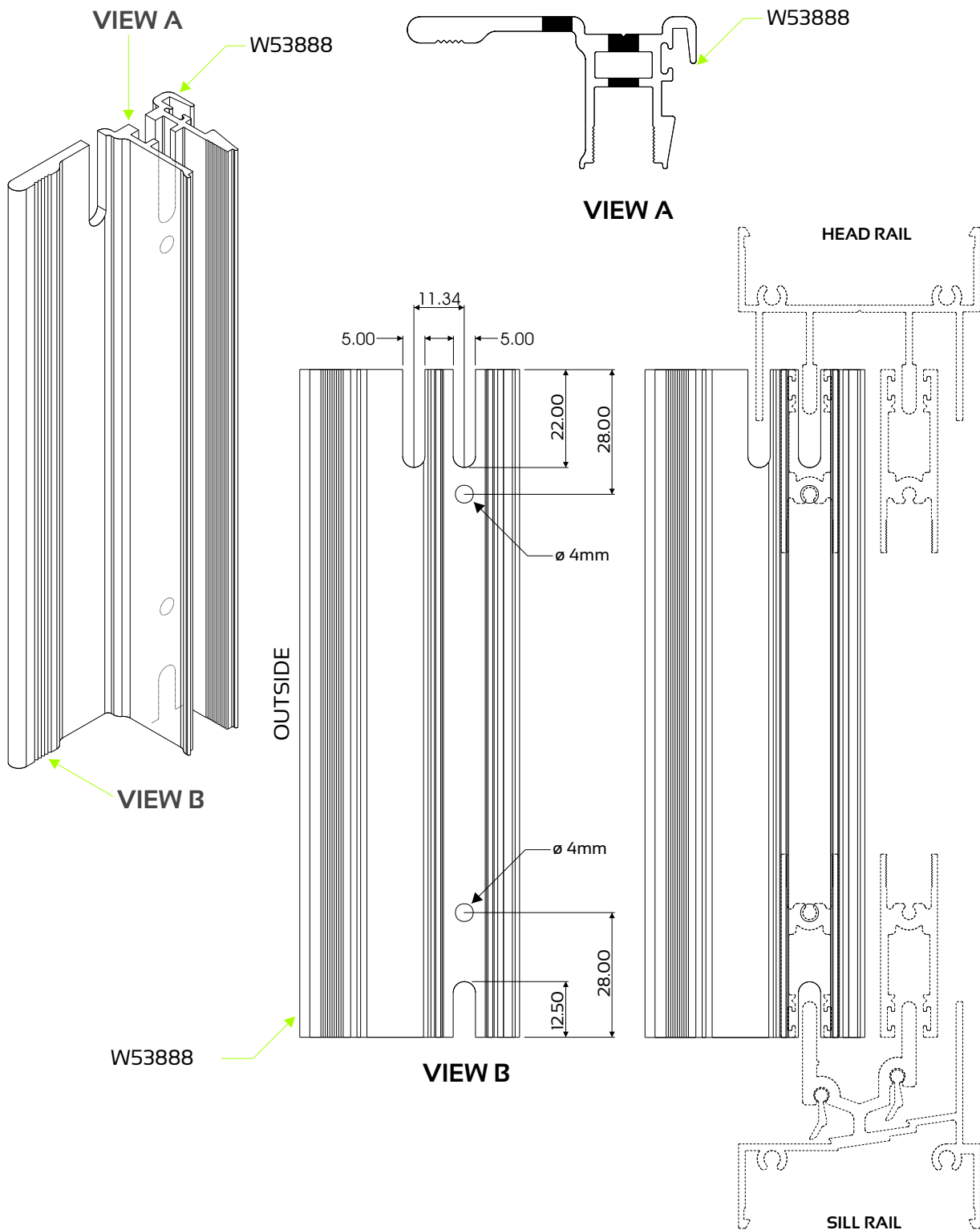



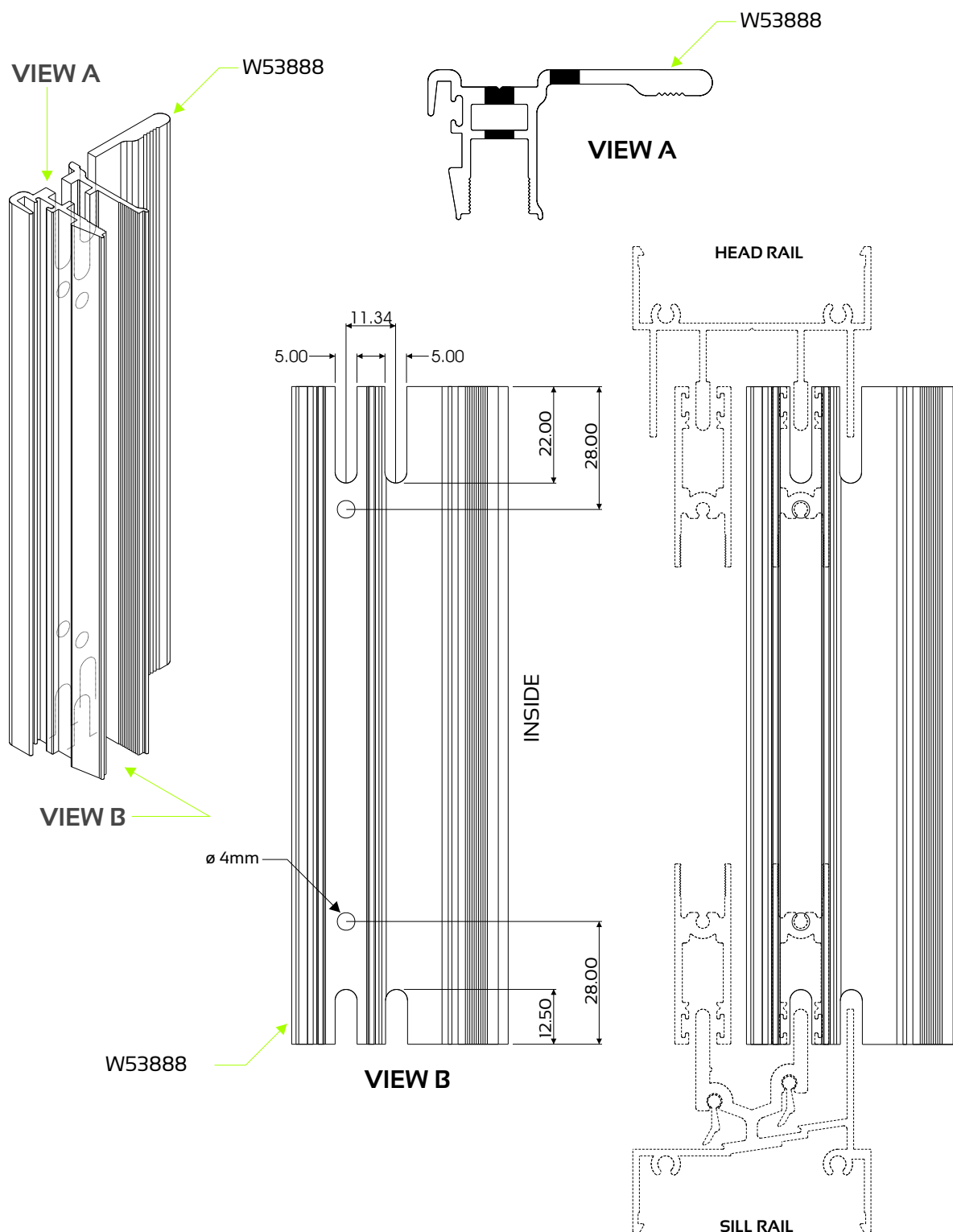

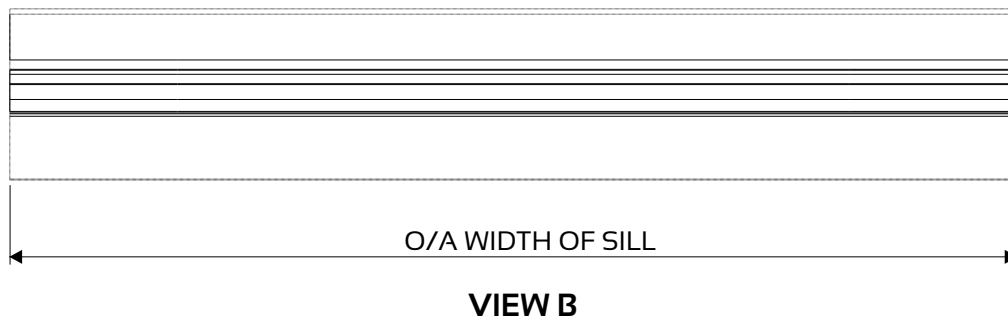
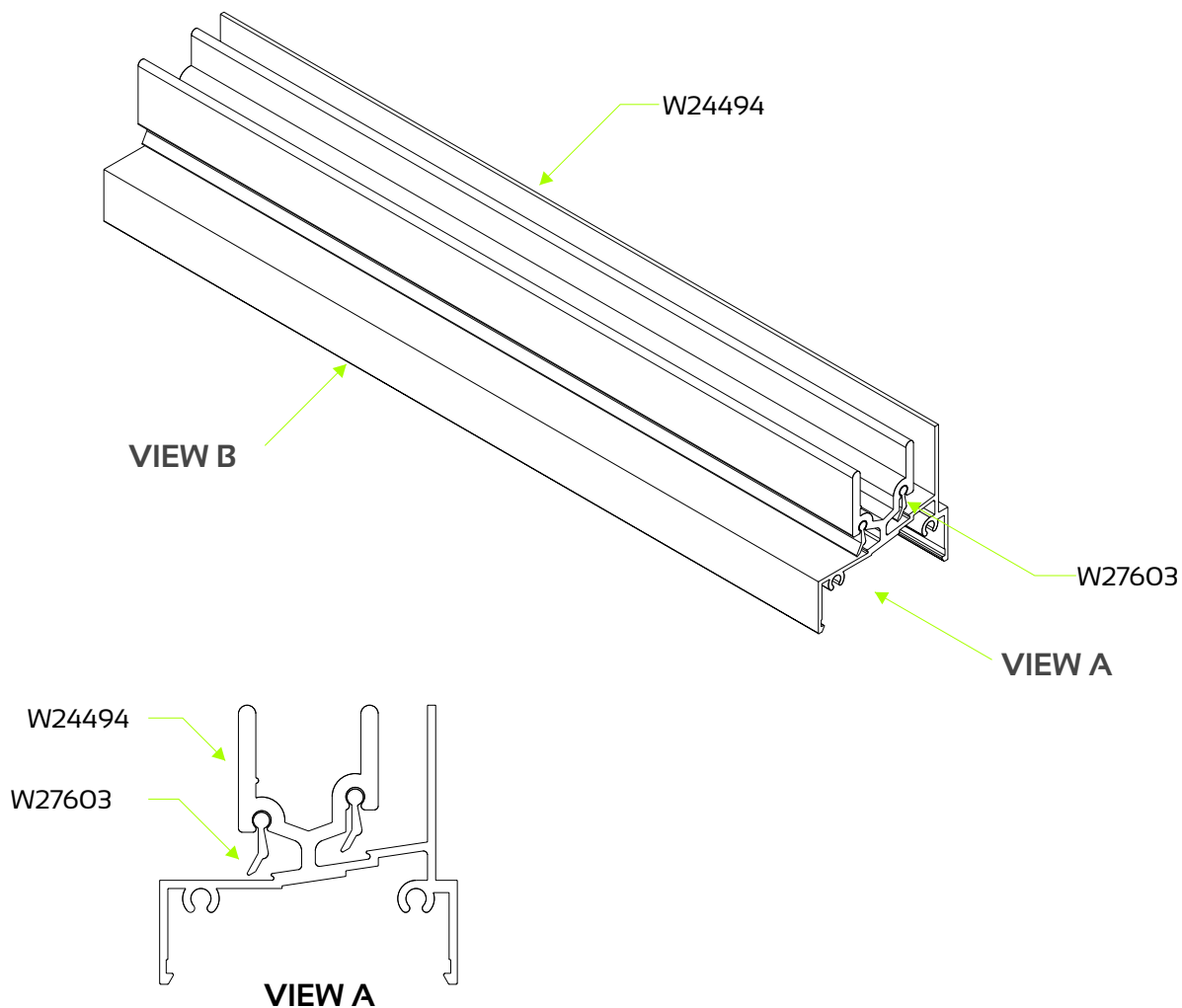

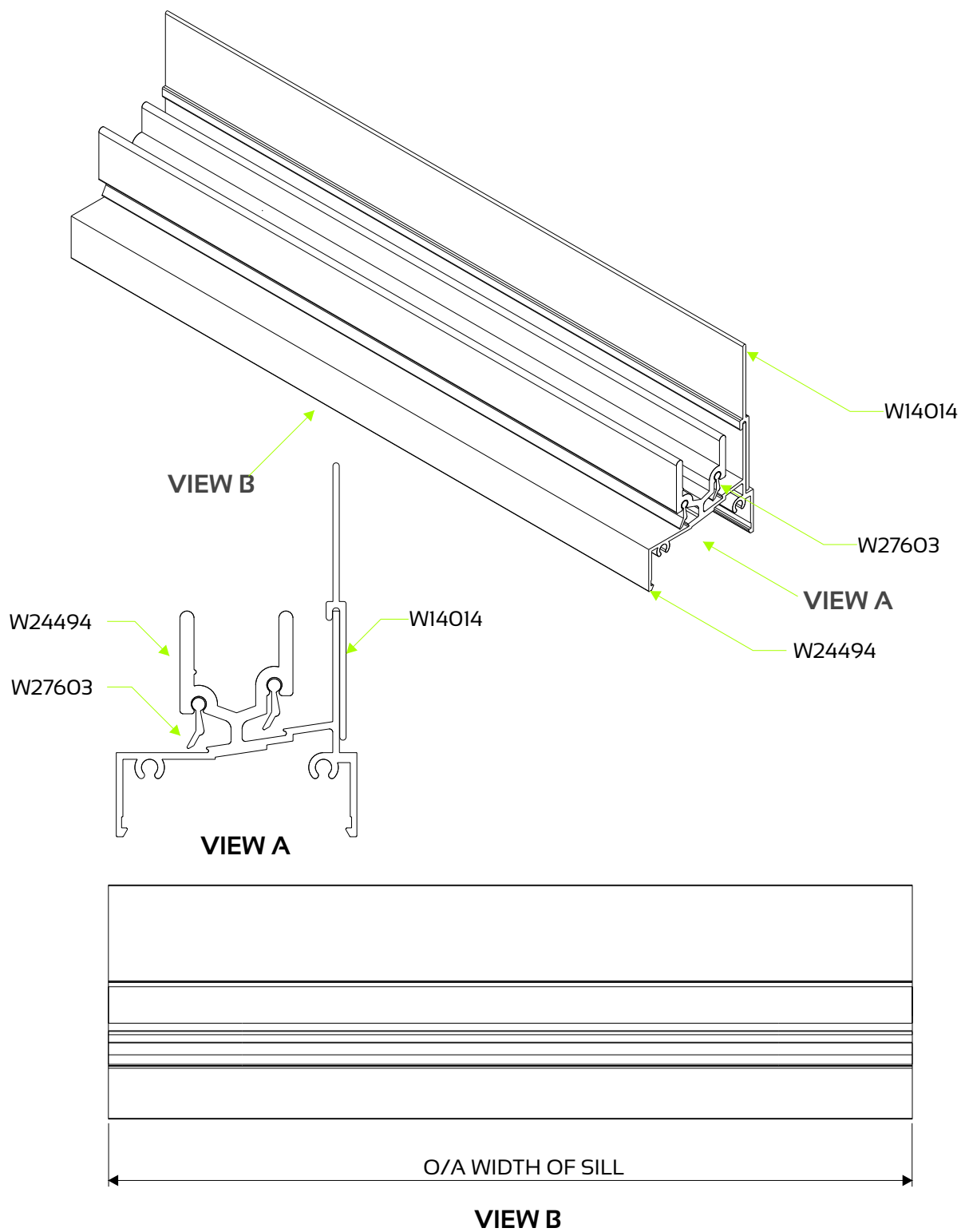

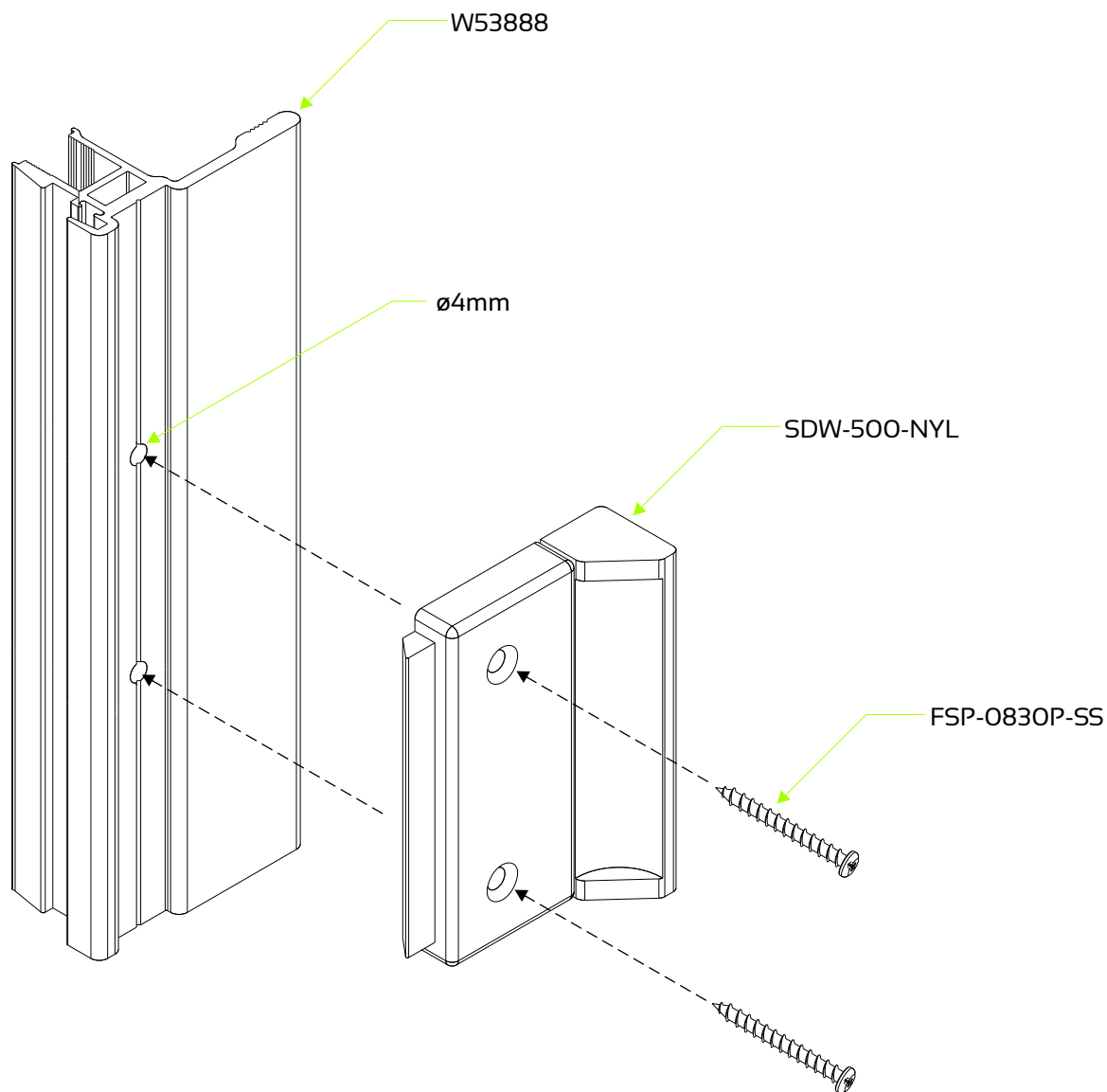

NOTE:  
HANDLE SET TO BE FITTED TO CENTRE OF  
INNER SASH INTERLOCKER SECTION

NOTE:  
ANTI LIFT BLOCKS TO BE FITTED TO  
TOP OF SASH OUTER JAMB

NOTE:  
ANTI LIFT BLOCKS TO BE FITTED TO  
TOP OF SASH INTERLOCKER

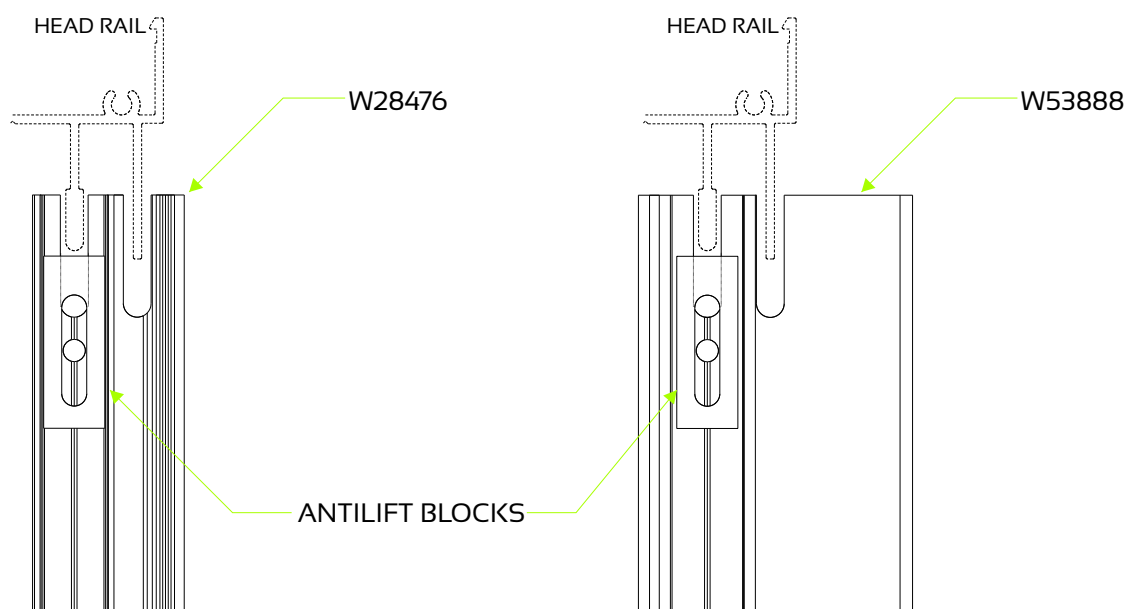

TO PASS A3 WATER AND WIND TEST THE FOLLOWING MODIFICATIONS MUST BE IMPLEMENTED.

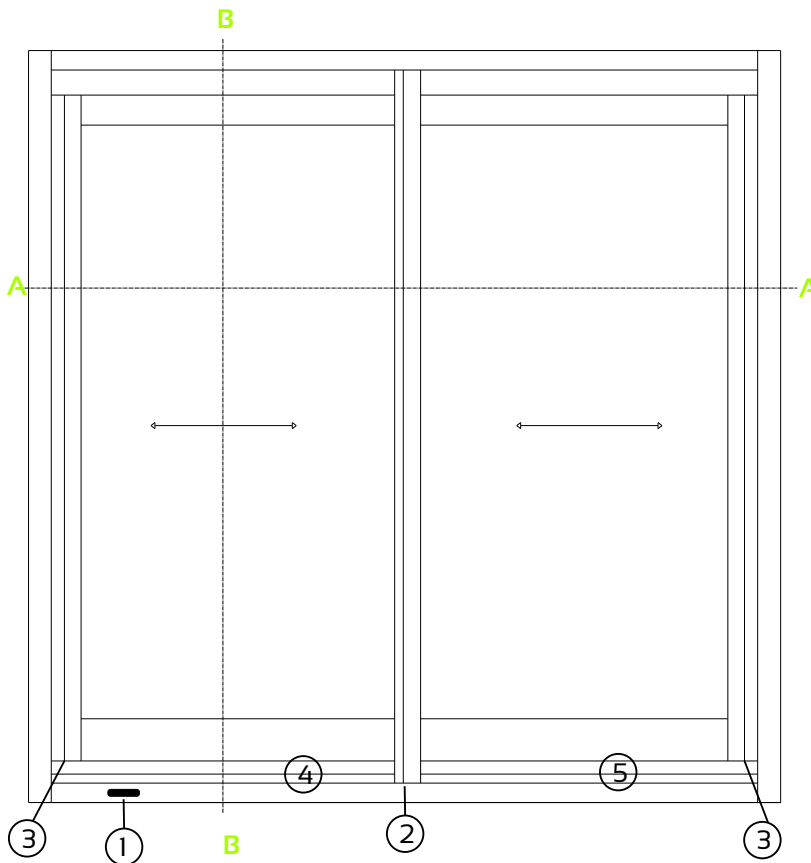

Horizontal Section

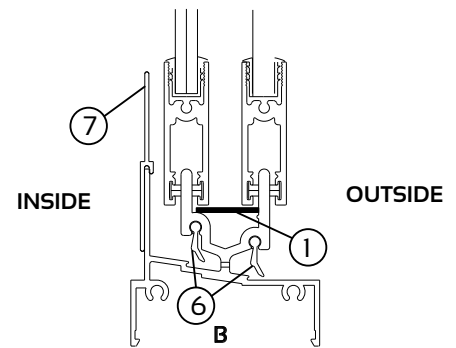
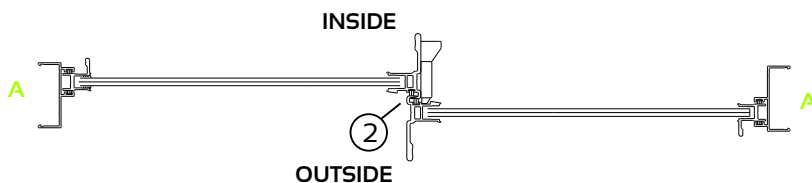

#### NOTES:

1. Screen off left side drain with aluminium flat.
2. Add woolpile to centre block on sill section.
3. Modified end blocks and add woolpile.
4. Shortened sliding rail slots to 6mm on bottom of both openers (+/- 40mm)
5. Close room-side right slide drain on sliding rail
6. Shorten drainage flaps by 0.5mm either side so they can move freely.
7. Add section W14014 to standard Sill.

## GLAZING

### 1. SELECTION OF GLAZING METHODS

#### 1.1 SETTING AND LOCATION BLOCKS

Glass-to-metal contact must be avoided at all times by using setting and location blocks having a hardness of 50° to 90° shore A durometer. Use only blocks made of Neoprene, EPDM, Silicone or other elastomeric material.

Setting blocks are to have a minimum thickness of 3mm and must be at least 27mm in length per square metre of glass area.

The position of the setting and location blocks is illustrated in Figure 2.

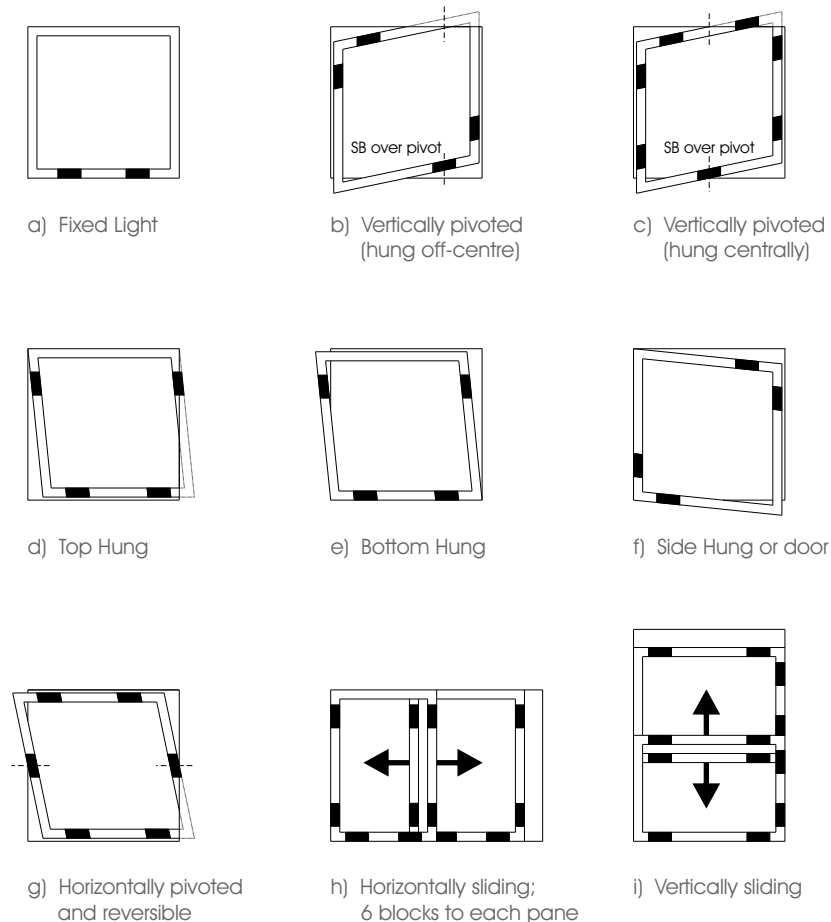

FIGURE 2 - POSITION OF SETTING AND LOCATION BLOCKS