



CLIP LOUVRE  
CLIP-IN FIXED DOOR VENTILATOR

#### *General Documentation Disclaimer*

This manual is intended as a manufacturing and installation advisory document. For correct specifications, sizing of profiles and structural information please consult the StarFront Application. If the information you require is not available through the StarFront Application, please contact your stockist before proceeding. It is advisable to have all sizing and performance criteria checked by a qualified structural engineer to ensure that the required criteria will be met.

All information, recommendations or advice contained in this documentation is given in good faith to the best of Wispeco's knowledge and is based on current procedures in effect.

Since the actual use of this documentation by the user is beyond the control of Wispeco, such use is within the exclusive responsibility of the user. Wispeco cannot be held responsible for any loss incurred through incorrect or faulty use of this documentation. Training of Wispeco systems is important for ensuring correct procedures in the manufacturing of products.

Great care has been taken to ensure that the information provided is correct.

Ensure that you have the latest available manual. The revision number and date can be checked on the latest StarFront version.

Wispeco will accept no responsibility for any errors and/or omissions, which may have inadvertently occurred.

#### *Specifications concerning products and applications*

This manual is based on standard configurations only. As there are many configurations not covered in this manual, contact your stockist with regards to a configuration not represented herein if required.

AutoDesk drawings (CAD Symbol Library) are available on request and can be issued with the consent of the Wispeco Technical Department.

All mechanical joints must be sealed with a **Crealco approved joint sealer**. Failure to correctly seal the joints can affect the performance of the system. Information on joint sealing can be found in the Cleaning & Maintenance Manual\*\* available for download from [www.crealco.co.za](http://www.crealco.co.za) or from StarFront.

All drawings in the Wispeco Documentation are NOT to scale and are used for illustrative purposes only.

Wispeco will not accept responsibility for the use of standard products since Wispeco does not know where these products are being installed.

The hardware recommended in this documentation is suitable for use in most atmospheric environments. When hardware is used in severe coastal environments the manufacturer of the hardware must be consulted.

For the coastal regions and any other high corrosion areas, the following is advised: to minimize phylliform corrosion use SurTec650 RTU spray during the manufacturing of aluminium profile systems. This should be applied, before assembly, on all pre-work aluminium where the powder coating covering has been removed thereby exposing the raw aluminium base.

The use of non-specified hardware or incorrect mechanical fasteners can adversely affect the mechanical and weathering performance of the system and we strongly advise against deviations. A Wispeco Consultant can advise you of any hardware issues and limitations with regard to this system.

The use of anti-magnetic stainless steel screws and aluminium pop rivets is recommended to reduce galvanic corrosion in harsh environments.

Fixing lugs on frames must be positioned as per the user manual and used in accordance to the AAMSA specifications. When profiles are screwed together the screw centres must also be according to the user manual or as specified by an engineer.

All glass used within Wispeco products must comply with SAGGA regulations. Laminated glass must not stand in water.

*\*\*For Cleaning and Maintenance of this system please download the Wispeco Installation, Cleaning and Maintenance Procedures from the Crealco website ([www.crealco.co.za](http://www.crealco.co.za)).*

**By continuing to use this documentation you acknowledge that you understand and accept the legal disclaimer.**

This manual must be read in conjunction with the Installation, Cleaning & Maintenance Document and the Performance Certificates for the relevant system. The manual must also be used in conjunction with the design and cutting list from the latest version of StarFront.



<b>Index .....</b>	<b>ii</b>
<b>Legal Disclaimer.....</b>	<b>1</b>

---

**General System**

Profile Identification.....	2
Hardware Identification.....	3
Cross-Sectional Details.....	4
Assembly Details.....	5

CLIP LOUVRE  
CLIP-IN FIXED DOOR VENTILATOR

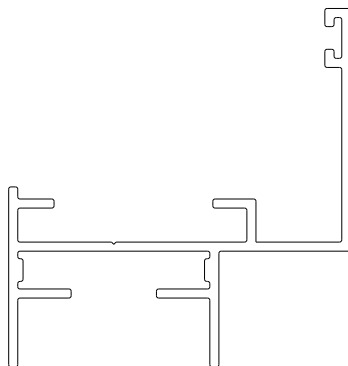

DIE No. W32417

Door Vent Frame

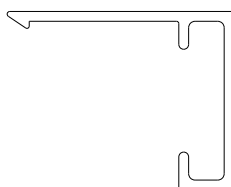

DIE No. W32416

Door Vent Clip

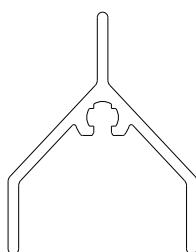

DIE No. W18079

Y-Louvre

RECOMMENDED CLIP LOUVRE DOOR VENT HARDWARE COMPONENTS

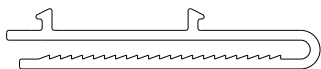

**GSN-HCP**  
Hairpin Clip

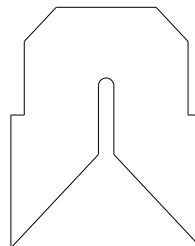

**PPS-LPY**  
Louvre Spacer



**GSL-48EPDM**  
Bubble Seal

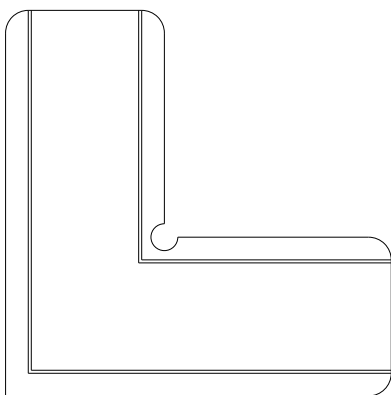

**LGC-F54-PVC**  
Plastic Cleat

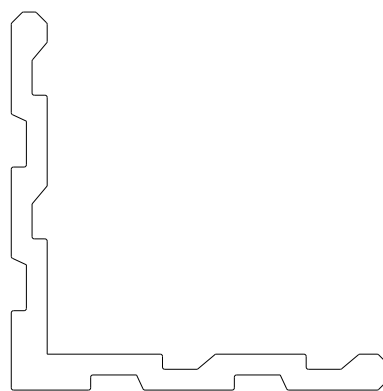

**W52695**  
Corner Cleat

# CLIP LOUVRE

CLIP-IN FIXED DOOR VENTILATOR

## PRODUCT MANUAL

### Cross-Sectional Detail

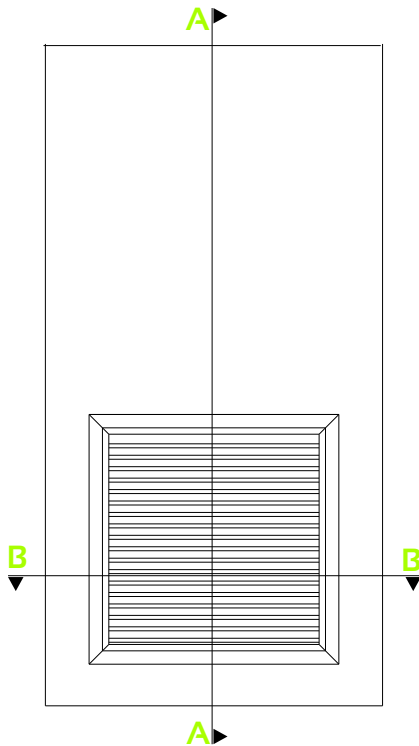

**SECTION B-B**  
Section not to scale

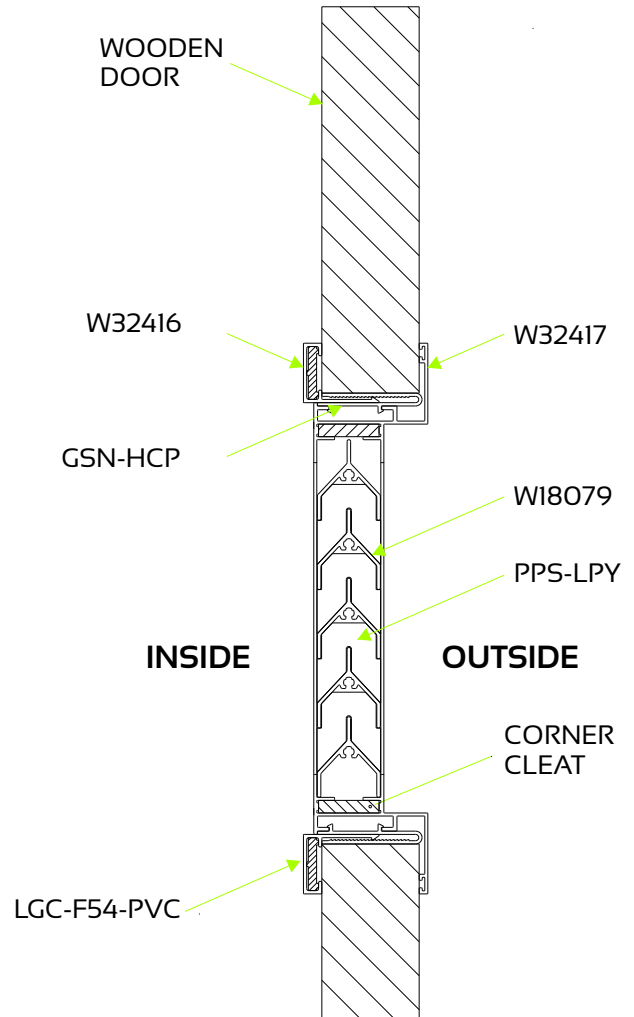

**SECTION A - A**  
Section not to scale

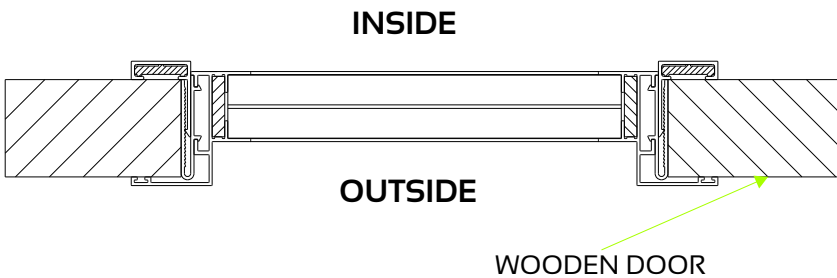

This manual must be read in conjunction with the Installation, Cleaning & Maintenance Document and the Performance Certificates for the relevant system. The manual must also be used in conjunction with the design and cutting list from the latest version of StarFront.

